

MAXWELL 24STB 24STC

10-speed Geared

MODEL	FINISH	PRODUCT CODE
24STB	Bronze	58245/B
24STC	Chrome	58246/C

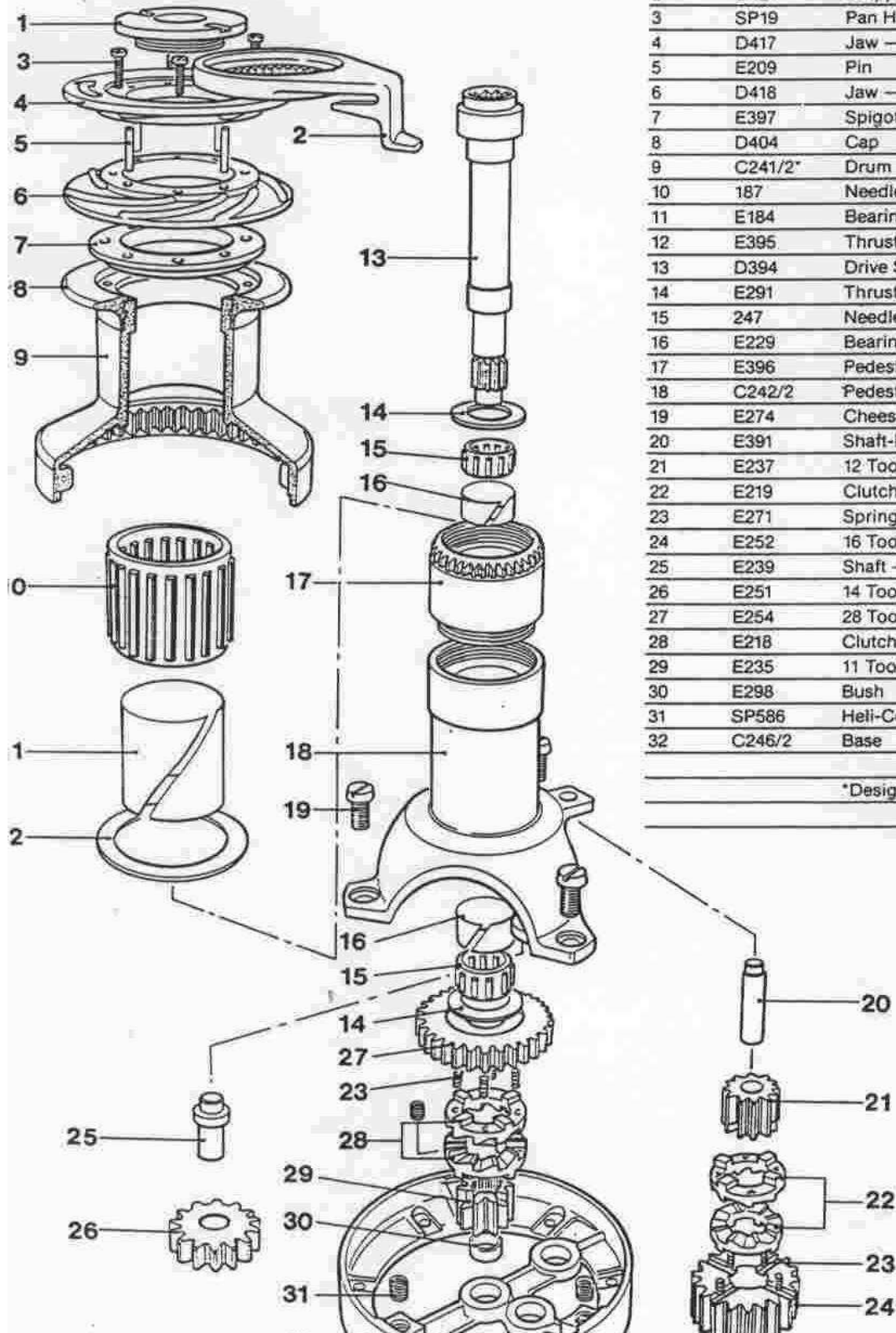

ITEM	PART No	DESCRIPTION	QTY
1	E423	Retaining Cap	1
2	D421	Stripper Arm	1
3	SP19	Pan Head Screw	4
4	D417	Jaw — Clockwise	1
5	E209	Pin	4
6	D418	Jaw — Anticlockwise	1
7	E397	Spigot Ring	1
8	D404	Cap	1
9	C241/2*	Drum	1
10	187	Needle Roller Bearing	1
11	E184	Bearing Inner Race	1
12	E395	Thrust Washer	1
13	D394	Drive Shaft	1
14	E291	Thrust Washer	2
15	247	Needle Roller Bearing	2
16	E229	Bearing Outer Race	2
17	E396	Pedestal Extension	1
18	C242/2	Pedestal	1
19	E274	Cheese Head Screw	3
20	E391	Shaft-Driven Gear Cluster	1
21	E237	12 Tooth Clutch Gear	1
22	E219	Clutch — Anticlockwise	2
23	E271	Spring	8
24	E252	16 Tooth Clutch Gear	1
25	E239	Shaft — Idler Gear	1
26	E251	14 Tooth Idler Gear	1
27	E254	28 Tooth Clutch Gear	1
28	E218	Clutch — Clockwise	2
29	E235	11 Tooth Clutch Gear — Splined	1
30	E298	Bush	1
31	SP586	Heli-Coil Insert	3
32	C246/2	Base	1

*Designate /B for Bronze or /C for Chrome