

# MAXWELL 17STB 17STC

## C 3-speed Geared — Ratcheting

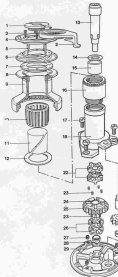

MODEL	SIZE	PRODUCT CODE
17STB	18mm	471030
17STC	19mm	471020

ITEM	PART NO.	DESCRIPTION	QTY
1	101	Rolling Pin	1
2	102	Spring Ring	1
3	103	Pin Head Screw	1
4	104	Pin — Clutch	1
5	105	Pin	1
6	106	Pin — Intermediate	1
7	107	Spring Ring	1
8	108	Cap	1
9	109	Cap	1
10	110	Output Gear Bearing	1
11	111	Bearing Inner Race	1
12	112	Input Gear	1
13	113	Input Shaft	1
14	114	Input Gear	1
15	115	Gear	1
16	116	Forward Ratchet	1
17	117	Clutch Gear Spring	1
18	118	Ratchet	1
19	119	Spring — Idle Gear	1
20	120	Spring — Idle Gear	1
21	121	Gear	1
22	122	Cap — Intermediate <b>2104</b>	1
23	123	Spring	1
24	124	Gear — Assembly with 117	1
25	125	Pin From Output Gear	1
26	126	Cap — Forward <b>2104</b>	1
27	127	Cap For Input	1
28	128	Gear	1
29	129	Gear	1

Designated by the letters A  
or B for design.

6 219-036<sup>A</sup> 446  
6 219-036<sup>B</sup> 445