

MAXWELL™ 23STA

Two-speed Geared

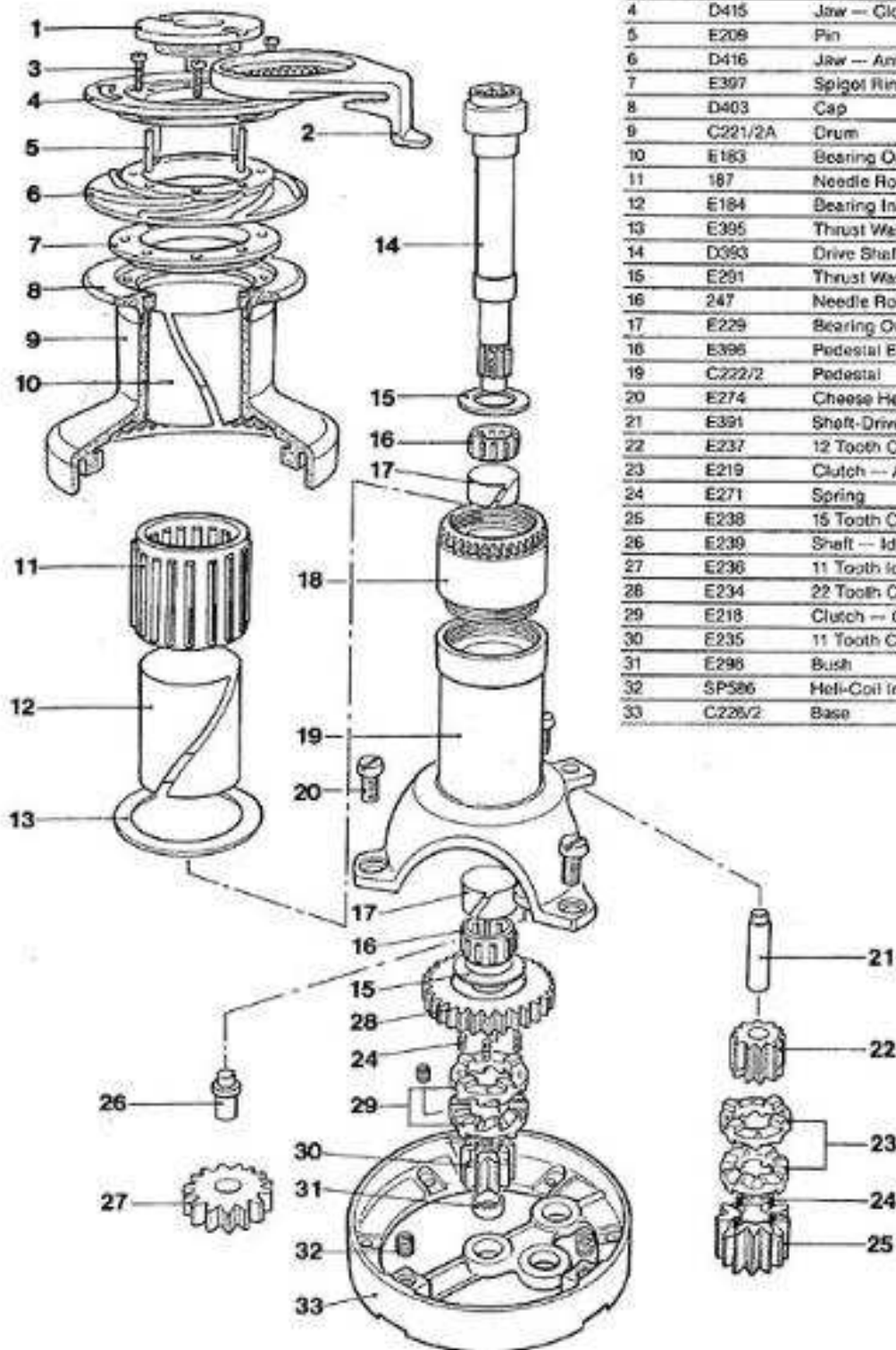

MODEL	FINISH	PRODUCT CODE
23STA	Alloy	58234

ITEM	PART No.	DESCRIPTION	QTY
1	E423	Retaining Cap	1
2	D420	Stripper Arm	1
3	SP19	Pan Head Screw	4
4	D415	Jaw -- Clockwise	1
5	E209	Pin	4
6	D416	Jaw -- Anticlockwise	1
7	E307	Spigot Ring	1
8	D403	Cap	1
9	C221/2A	Drum	1
10	E183	Bearing Outer Race	1
11	187	Needle Roller Bearing	1
12	E184	Bearing Inner Race	1
13	E395	Thrust Washer	1
14	D093	Drive Shaft	1
15	E291	Thrust Washer	2
16	247	Needle Roller Bearing	2
17	E229	Bearing Outer Race	2
18	E386	Pedestal Extension	1
19	C222/2	Pedestal	1
20	E274	Cheese Head Screw	3
21	E391	Shaft-Driven Gear Cluster	1
22	E237	12 Tooth Clutch Gear	1
23	E219	Clutch -- Anticlockwise	2
24	E271	Spring	8
25	E238	15 Tooth Clutch Gear	1
26	E239	Shaft -- Idler Gear	1
27	E236	11 Tooth Idler Gear	1
28	E234	22 Tooth Clutch Gear	1
29	E218	Clutch -- Clockwise	2
30	E235	11 Tooth Clutch Gear -- Splined	1
31	E298	Bush	1
32	SP586	Heli-Coil Insert	3
33	C226/2	Base	1

Drawing Number
C 100053