

-- Below Pages Contain Drawings for the Cherubini Hunter 36 and 37 -- From the Hunter Owner's Manual

Hunter 36

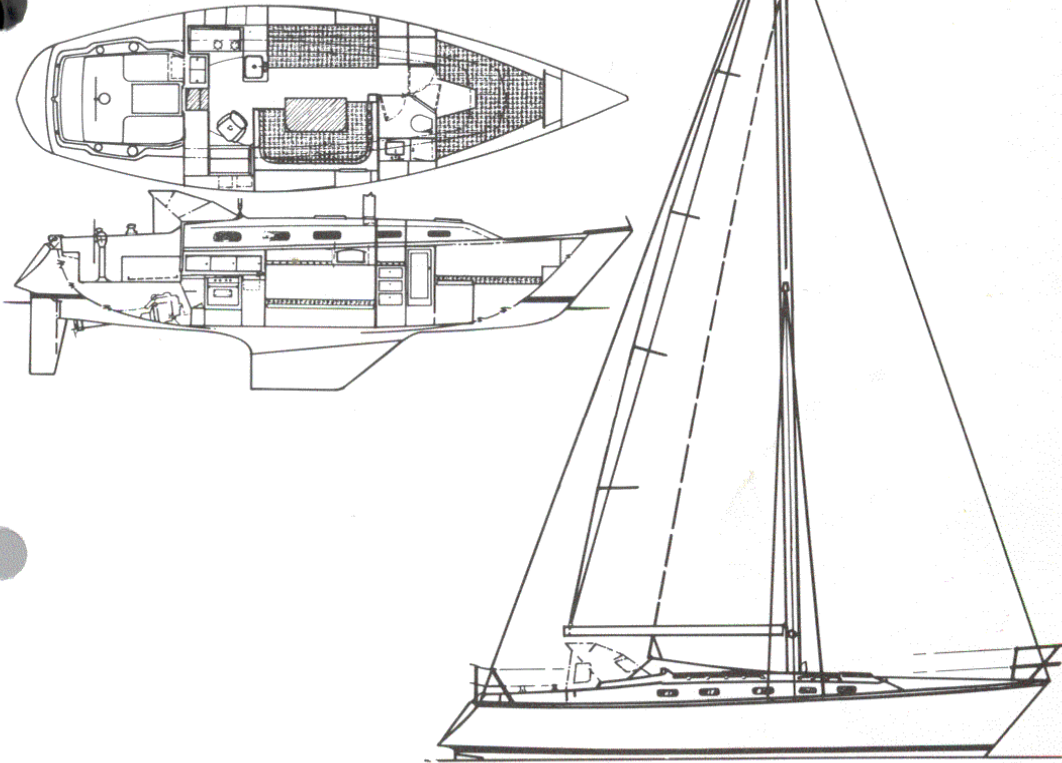

SPECIFICATIONS:





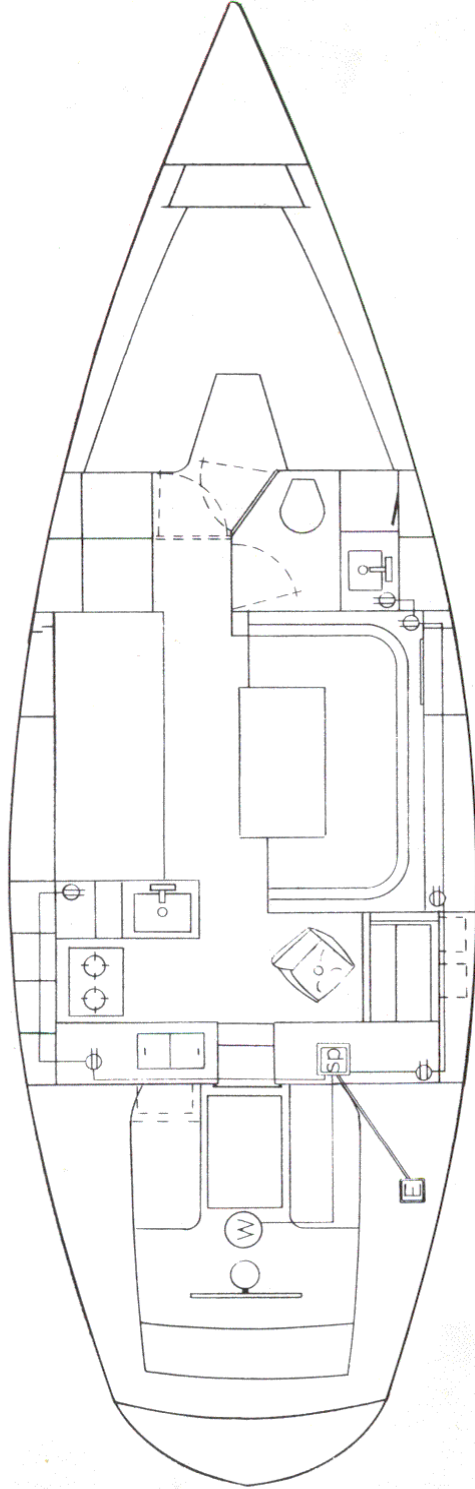

E (Mainsail foot)	12'9"	3.68 m.
J (Foretriangle base)	14'9"	4.29 m.
P (Mainsail luff)	41'0"	12.40 m.
I (Foretriangle ht.)	46'6"	14.03 m.
L.O.A.	35'11"	10.80 m.
L.W.L.	29'6"	9.00 m.
Beam	11'1"	3.40 m.
Sail area	621 sq. ft.	57.69 sq. m.
Displacement	13,500 lbs.	6,125.20 kg.
Ballast	6,000 lbs.	2,724.00 kg.
Draft	4'11"	1.40 m.
Mast height	45'6"	13.87 m.
from waterline	50'6"	15.39 m.
Headroom	6'5"	1.96 m.

Hunter 36

WIRING DIAGRAM (AC)



LEGEND

-  ELECTRICAL DECK PLATE
-  SWITCH PANEL
-  WATER HEATER
-  110V OUTLET
-  10/3 MARINE POWER CABLE (AC SUPPLY)
-  14/3 MARINE POWER CABLE (TO OUTLETS/WATER HEATER)

Hunter 36

PLUMBING DIAGRAM

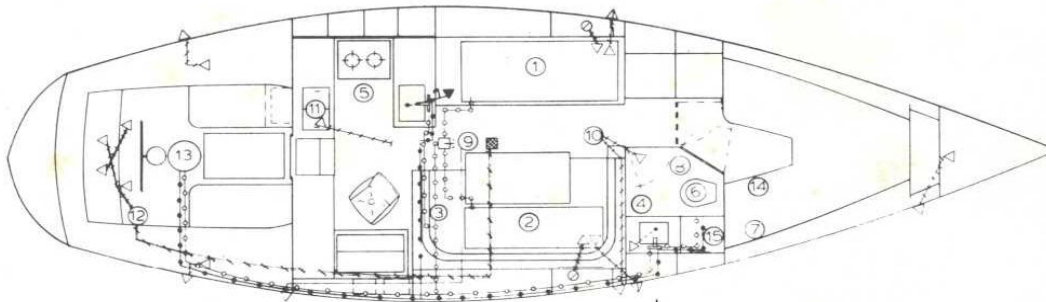

SUBSYSTEMS
FRESH WATER
WASTE DISPOSAL
DRAINS

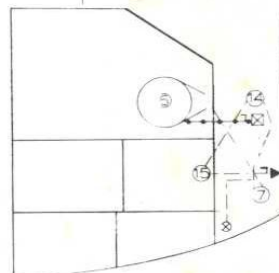

HEAD DETAIL
◆◆ 3/4" BLK HOSE

LEGEND:	HOSES & FITTINGS:
① WATER TANK (PORT)	◆◆◆◆ 5/8" WHITE HOSE (COLD WATER)
② WATER TANK (STBD)	◆◆◆◆ 5/8" WHITE HOSE (HOT WATER)
③ WATER PUMP	◆◆◆◆ 3/4" SHIELDVAC (W/CUFFS)
④ VANITY	◆◆◆◆ 1-1/2" SHIELDVAC (W/CUFFS)
⑤ GALLEY	◆◆◆◆ 1-1/4" SHIELDFLEX (GREEN)
⑥ HEAD	◆◆◆◆ 1-1/2" SHIELDFLEX (GREEN)
⑦ HOLDING BAG	△ THRU HULL (PLASTIC)
⑧ SHOWER	▲ THRU HULL (BRONZE)
⑨ BILGE PUMP (ELEC.)	⊙ DECK PLATE (WATER)
⑩ SUMP PUMP/SHOWER	⊙ DECK PLATE (WASTE)
⑪ ICEBOX	⊗ SALT WATER PICKUP
⑫ BILGE PUMP (MANUAL)	⊗ NAVY STRAINER
⑬ WATER HEATER	△ WATER & WASTE VENTS
⑭ WASTE PUMP (MANUAL)	⌋ GATE VALVE
⑮ 1-1/2" VENTED LOOP (BRZ)	⊞ 3-WAY VALVE

Hunter 36

WIRING DIAGRAM (DC)

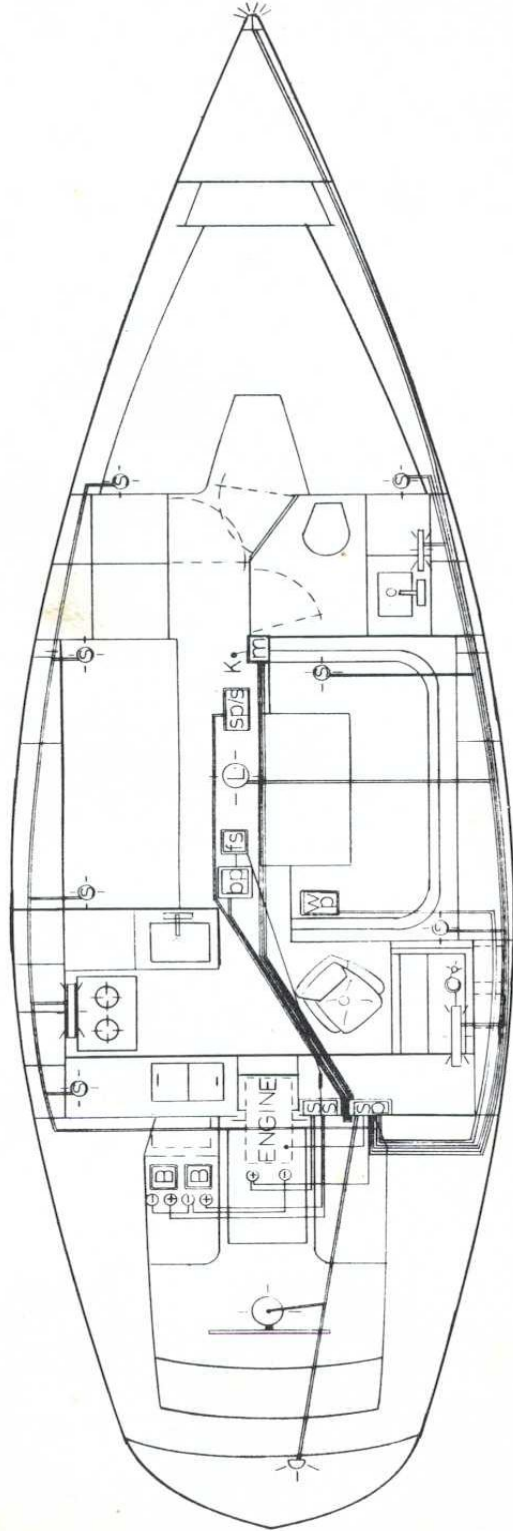

WIRING NOTES:

COLOR	GAUGE	APPLICATION
RED	4	BATTERY CABLE/SAFETY MAIN SW
WHITE	8	MAST GROUND
RED	10	DC SUPPLY TO SWITCH PANEL
RED	12	WATER PUMP
BLUE	16	CABIN LIGHTS
WHITE	16	RUNNING LIGHTS (BOW)
GREEN	16	STEERING LIGHTS (STERN/COMPASS)
BROWN	16	ENGINE LIGHT
TAN	16	BILGE PUMP
YELLOW	16	BILGE FLOAT SWITCH
	16	SUMP PUMP/SHOWER

● ALL LEADS (EXCEPT FLOAT SWITCH AND MAST GROUND) ARE RUN WITH A BLACK GROUND OF EQUAL GAUGE THESE ARE CONNECTED TO A COMMON GROUND AT THE SWITCH PANEL WHICH IS GROUNDED TO THE ENGINE WITH A 10 GAUGE BLACK WIRE.

LEGEND:

	BATTERY (2-85 A)		SM. ROUND LIGHT
	SWITCH PANEL		LG. ROUND LIGHT
	SAFETY MAIN SWITCH		LG. FLOOR LIGHT
	WATER PUMP		SM. FLOOR LIGHT
	BILGE PUMP (500 GPH)		CHART LIGHT
	BILGE FLOAT SWITCH		IN-LINE FUSE
	SUMP PUMP/SHOWER (750 GPH)		FLUOR. LIGHT AT CHART TABLE IS RED.

ELECTRICAL DIAGRAM (DC)
HUNTER 36
NO SCALE

Hunter 37

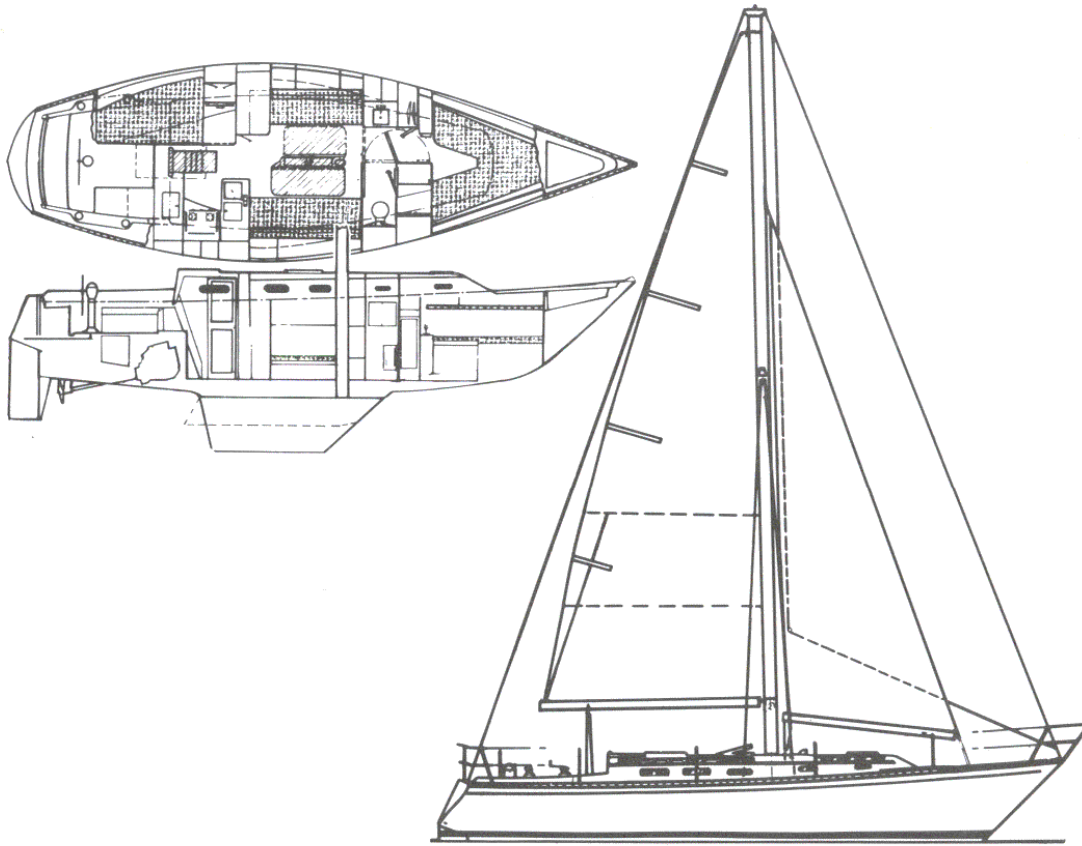

SPECIFICATIONS:

E (Mainsail foot)	13'0"	3.90 m.
J (Foretriangle base)	17'0"	5.10 m.
P (Mainsail luff)	39'6"	11.96 m.
I (Foretriangle ht.)	46'2"	14.05 m.
L.O.A.	37'0"	11.30 m.
L.W.L.	30'0"	9.10 m.
Beam	11'10 1/2"	3.40 m.
Sail area	710 sq. ft.	65.96 sq. m.
Displacement	17,800 lbs.	8,074.08 kg.
Ballast	Shoal 7,150 lbs.	3,246.00 kg.
	Deep 6,850 lbs.	3,110.00 kg.
Draft	Shoal 4'0"	1.20 m.
	Deep 5'1"	1.55 m.
Mast height from waterline	44'11"	13.69 m.
	50'0"	15.24 m.
Headroom	6'4"	1.93 m.

Hunter 37

WIRING DIAGRAM (AC)

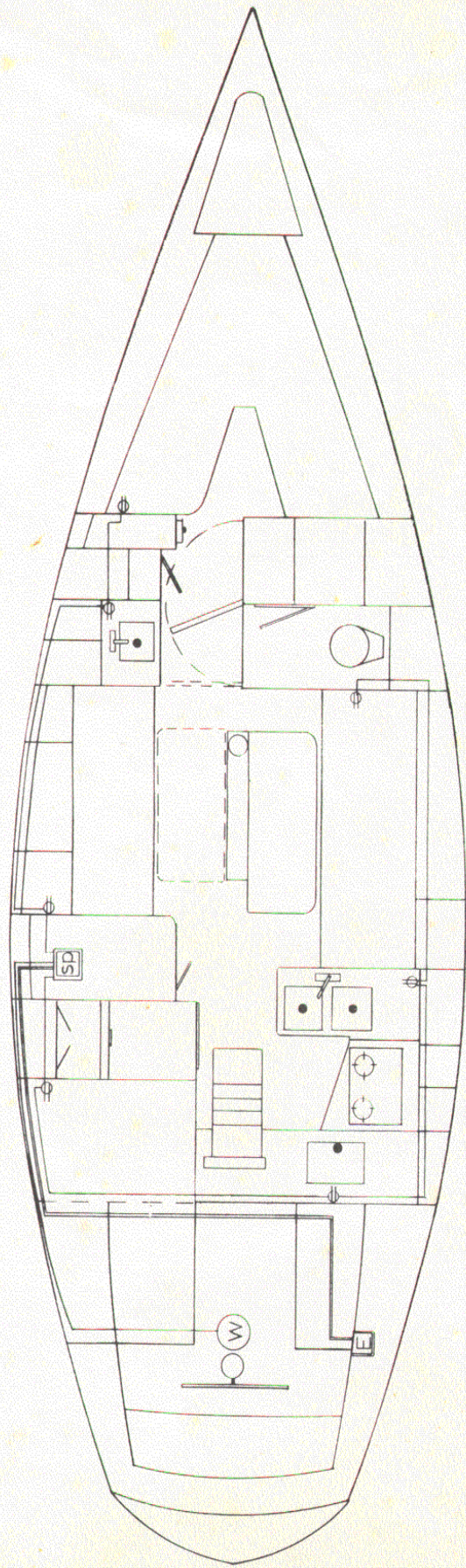

LEGEND:	
E	ELECTRICAL DECK PLATE
SP	SWITCH PANEL
W	WATER HEATER
⊕	110V OUTLETS
—	10/3 MARINE POWER CABLE (AC SUPPLY)
—	14/3 MARINE POWER CABLE (TO OUTLETS/WATER HEATER)

Hunter 37

PLUMBING DIAGRAM

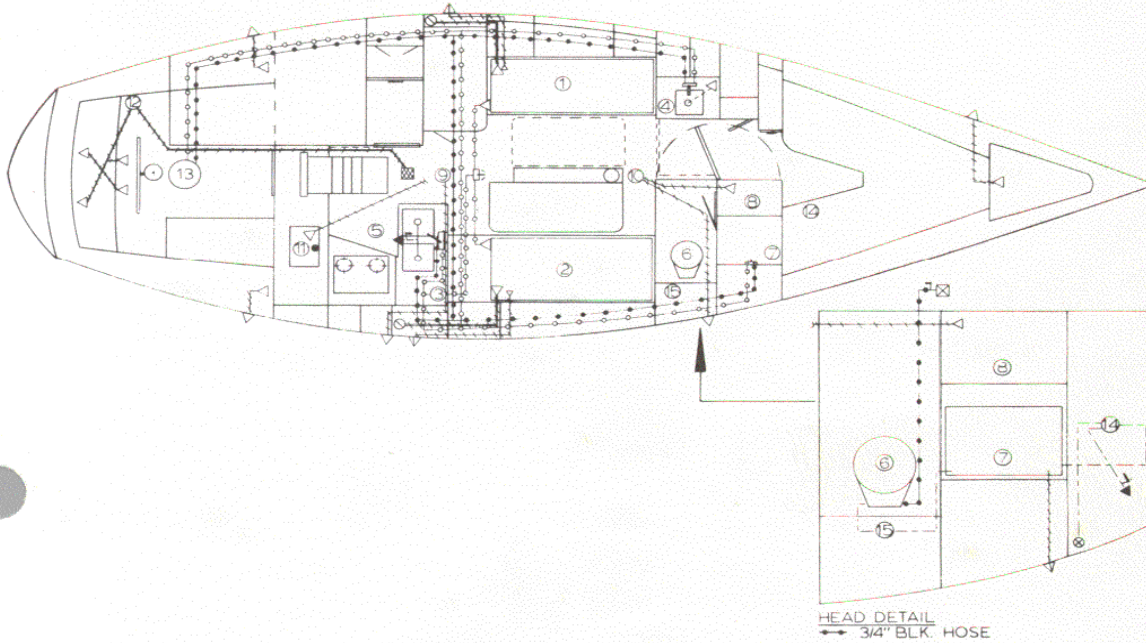

LEGEND	HOSES & FITTINGS
① WATER TANK (PORT)	—○— 5/8" WH. HOSE (COLD WATER)
② WATER TANK (STBD)	—●— 5/8" WH. HOSE (HOT WATER)
③ WATER PUMP	—○— 3/4" SHIELDVAC (W/CUFFS)
④ VANITY	—○— 1-1/2" SHIELDVAC (W/CUFFS)
⑤ GALLEY	—○— 1-1/4" SHIELDFLEX (GREEN)
⑥ HEAD	—○— 1-1/2" SHIELDFLEX (GREEN)
⑦ HOLDING TANK	△ THRU HULL (PLASTIC)
⑧ SHOWER	▲ THRU HULL (BRONZE)
⑨ BILGE PUMP (ELEC.)	○ DECK PLATE (WATER)
⑩ SUMP PUMP/SHOWER (ELEC.)	⊗ DECK PLATE (WASTE)
⑪ ICEBOX	⊗ SALT WATER PICKUP
⑫ BILGE PUMP (MANUAL)	⊗ NAVY STRAINER
⑬ WATER HEATER	△ WATER & WASTE VENTS
⑭ WASTE PUMP (MANUAL)	7 GATE VALVE
⑮ 1-1/2" VENTED LOOP (BRZ)	⊞ 3-WAY VALVE

HEAD DETAIL
 ↔ 3/4" BLK. HOSE

SUBSYSTEMS:
 FRESH WATER
 WASTE DISPOSAL
 DRAINS

Hunter 37

WIRING DIAGRAM (DC)

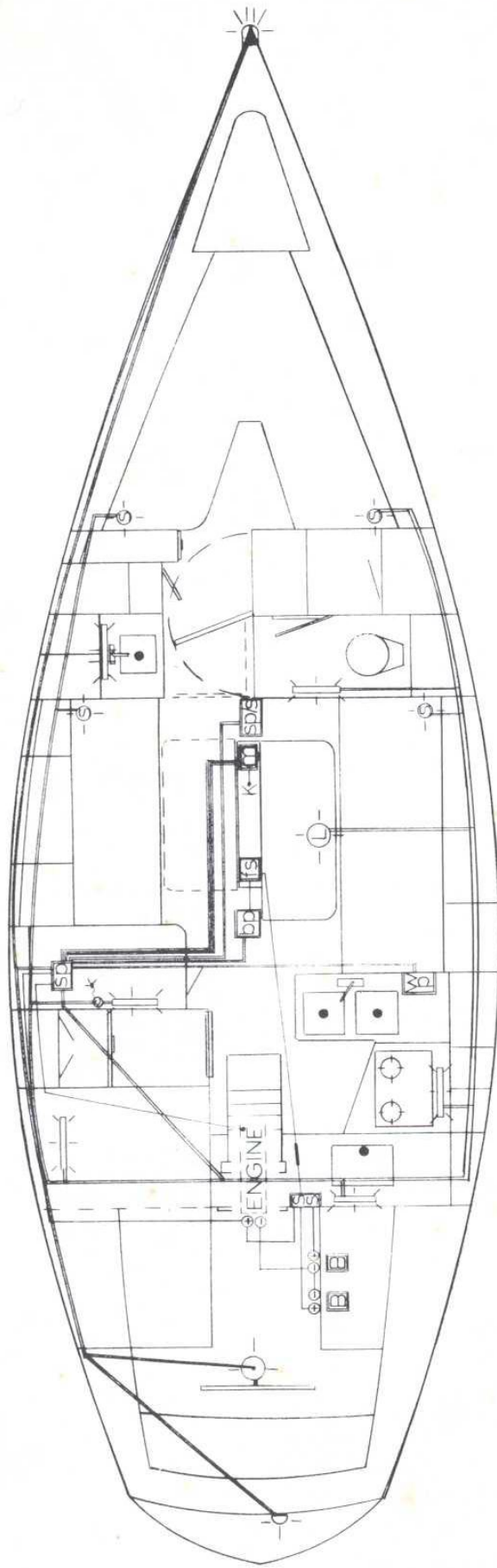

LEGEND:

	BATTERY (2-85 A.)		SM. ROUND LIGHT
	SWITCH PANEL		LG. ROUND LIGHT
	SAFETY MAIN SWITCH		LG. FLOOR LIGHT
	WATER PUMP		SM. FLOOR LIGHT
	BILGE PUMP (1500 GPH)		CHART LIGHT
	BILGE FLOAT SWITCH		IN-LINE FUSE
	SUMP PUMP/SHOWERS (750 GPH)		FLOOR LIGHT AT CHART TABLE IS RED.
	MAST		

WIRING NOTES:

COLOR	GAUGE	APPLICATION
RED	4	BATTERY CABLE/SAFETY MAIN SWITCH
WHITE	8	MAST GROUND
RED	10	DC SUPPLY TO SWITCH PANEL
RED	12	WATER PUMP
BLUE	16	CABIN LIGHTS
WHITE	16	RUNNING LIGHTS (BOW)
		" (STERN/COMPASS)
GREEN	16	STEERING LIGHTS
RED	16	ANCHOR LIGHT
BROWN	16	BILGE PUMP
TAN	16	BILGE FLOAT SWITCH
YELLOW	16	SUMP PUMP/SHOWERS
		* ALL LEADS EXCEPT FLOOR SWITCH AND MAST GROUND ARE RUN WITH A BLACK GROUND OF EQUAL GAUGE.
		THESE ARE CONNECTED TO A COMMON GROUND AT THE SWITCH PANEL WHICH IS GROUND TO THE ENGINE WITH A 10 GAUGE BLACK WIRE.