

Hunter 22

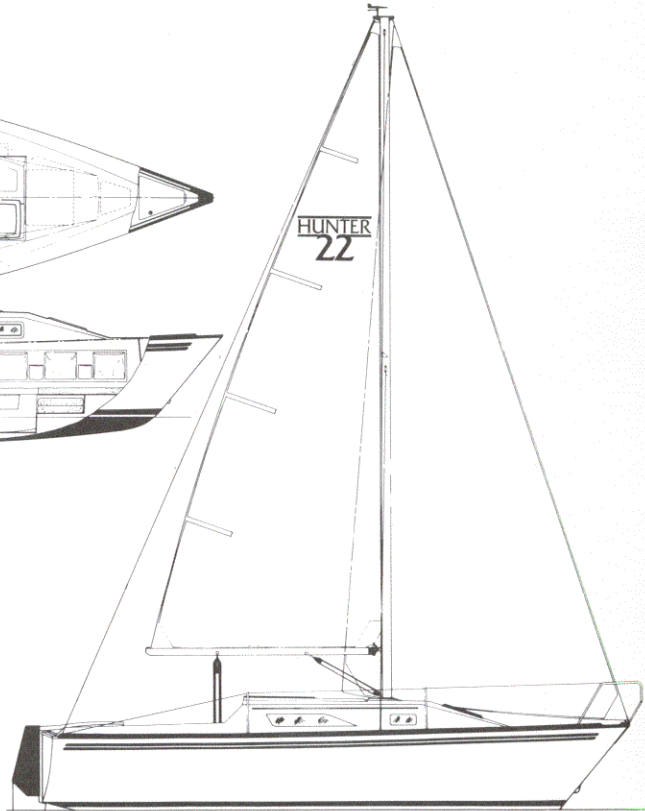
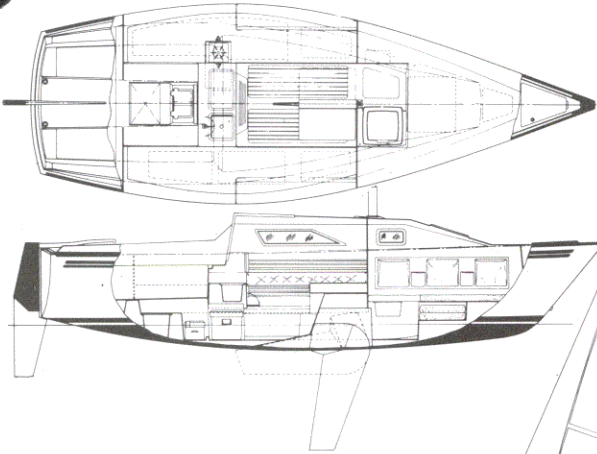

SPECIFICATIONS:

E (Mainsail foot)	8'9"	2.67 m.
J (Foretriangle base)	9'0"	2.74 m.
P (Mainsail luff)	23'6"	7.16 m.
I (Foretriangle ht.)	27'0"	8.23 m.
L.O.A.	22'3"	6.78 m.
L.W.L.	18'4"	5.59 m.
Beam	7'11"	2.53 m.
Sail area	225 sq. ft.	68.6 sq. m.
Displacement	2600 lbs.	1179.4 kg.
Ballast (cast internal)	1200 lbs.	544.3 kg.
Draft	board up 23"	58.4 cm.
	board down 5'0"	1.52 m.
Mast height	26'0"	7.92 m.
from waterline	30'3"	9.22 m.

Hunter 25

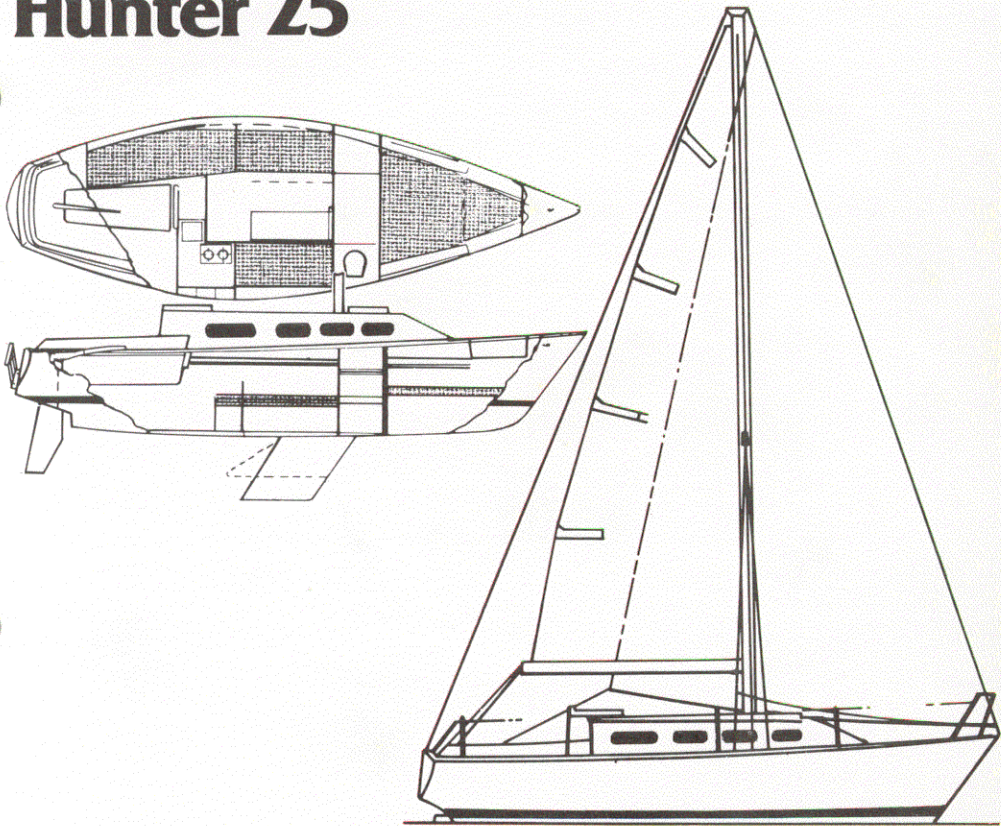

SPECIFICATIONS:

E (Mainsail foot)	8'0"	2.40 m.
J (Foretriangle base)	10'6"	3.15 m.
P (Mainsail luff)	24'9½"	7.54 m.
I (Foretriangle ht.)	30'0"	9.10 m.
L.O.A.	25'0"	7.60 m.
L.W.L.	20'2"	6.15 m.
Beam	8'0"	2.40 m.
Sail area	256 sq. ft.	23.78 sq. m.
Displacement	4,400 lbs.	1,995.80 kg.
Ballast	Shoal 2,000 lbs.	908.00
	Deep 1,800 lbs.	817.20 kg.
Draft	Shoal 2'11"	.88 m.
	Deep 3'11"	1.18 m.
Mast height	28'8"	8.70 m.
from waterline	34'1"	10.32 m.

Hunter 25

PLUMBING DIAGRAM

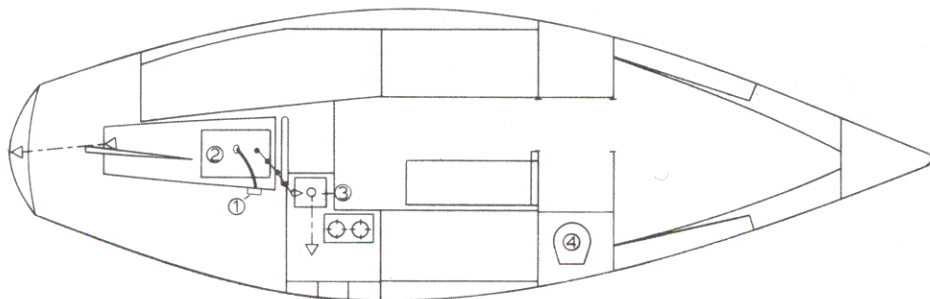

- LEGEND:**
- ① WATER FILL PLATE (UNDER STBD COCKPIT SEAT)
 - ② 15 GAL. WATER BAG
 - ③ GALLEY
 - ④ MANSFIELD SANI-POTTI (PORTABLE)

- SYMBOLS:**
- 5/8" WHITE REINF. HOSE
 - - - - - 1-1/2" SHIELDFLEX (GRN)
 - — — — — 1-1/2" SHIELDVAC
 - — — — — W/HOSE CUFFS
 - △ THRU-HULL (PLASTIC) — — — — —
 - SIZE TO MATCH AT-TACHED HOSE

Hunter 25

WIRING DIAGRAM (DC)

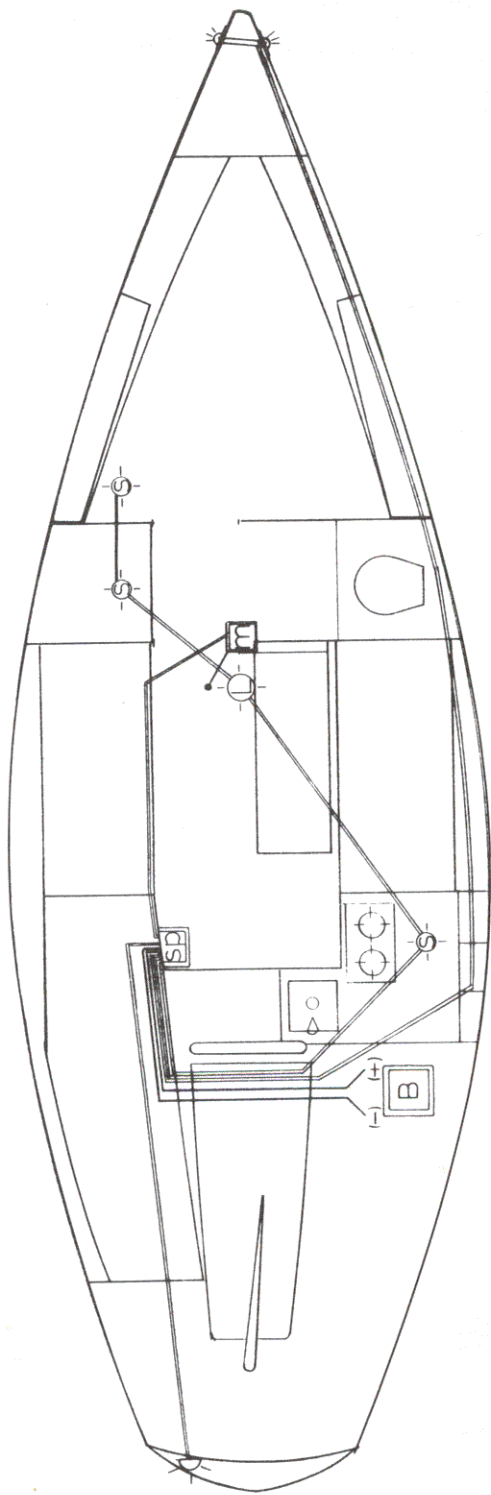

LEGEND:

	BATTERY (72 A)
	SWITCH PANEL
	MAST LIGHT
	CABIN LIGHT
	LARGE LIGHT

WIRING NOTES:

COLOR	GAUGE	APPLICATION
RED	6	BATTERY CABLE
WHITE	8	MAST GROUND
BLUE	16	CABIN LIGHTS
GREY	16	RUNNING LIGHTS (BOW)
WHITE	16	" (STERN)
RED	16	STEAMING LIGHTS

● ALL LEADS ARE RUN WITH A BLACK GROUND OF EQUAL GAUGE. THESE ARE CONNECTED TO A COMMON GROUND AT THE SWITCH PANEL.
 ● THE MAST GROUND HAS NO LEAD.

Hunter 27

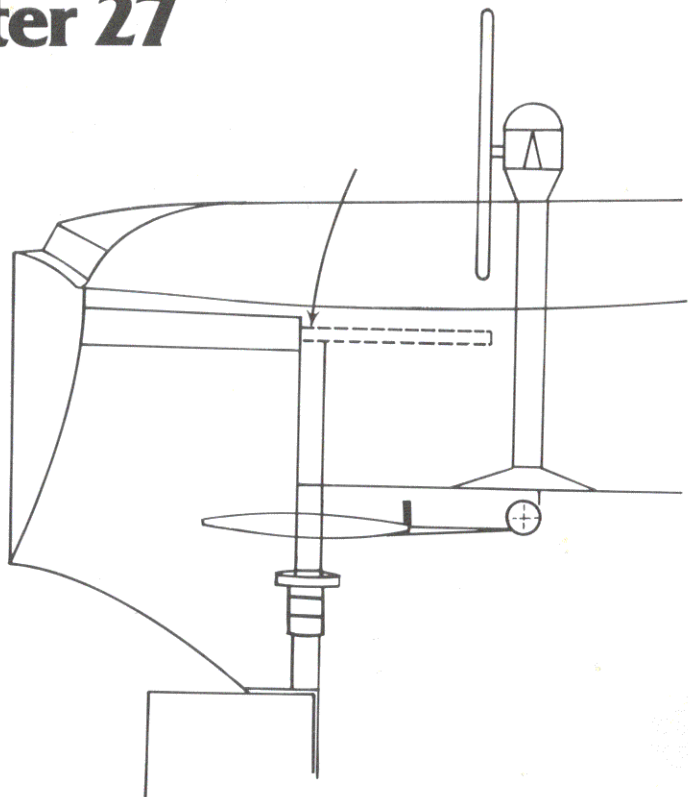

IMPORTANT LOCATIONS

EMERGENCY TILLER INSTALLATION: lift lazerette seat, fit emergency tiller into top of rudder shaft.

DIESEL FILLER: starboard cockpit coaming.

WATER FILLER: under V-berth in forepeak.

WASTE PUMP OUT: starboard side deck forward.

DOCKSIDE POWER OUTLET: outside port cockpit coaming.

Hunter 27

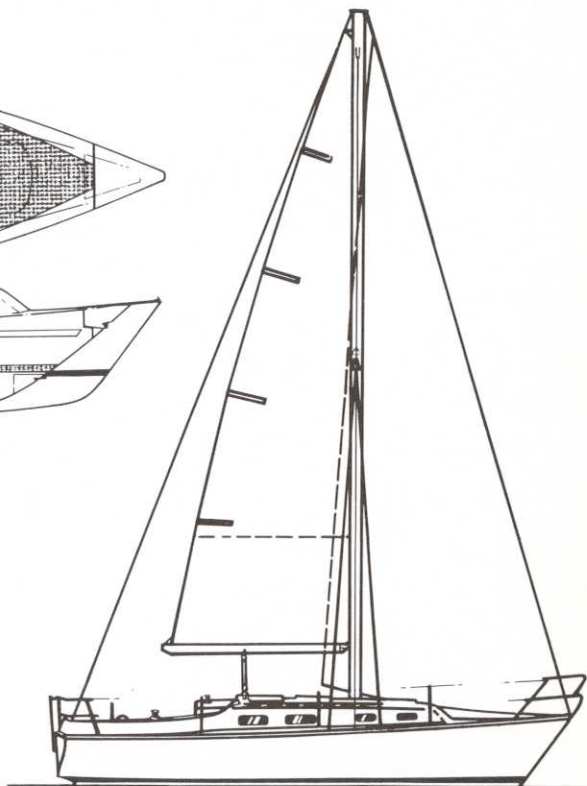
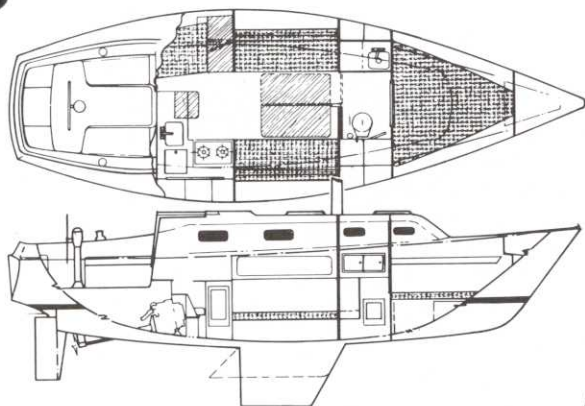

SPECIFICATIONS:

E (Mainsail foot)	9'11"	2.85 m.
J (Foretriangle base)	11'3"	3.37 m.
P (Mainsail luff)	32'4"	9.86 m.
I (Foretriangle base)	37'8"	11.48 m.
L.O.A.	27'2"	8.20 m.
L.W.L.	22'0"	6.70 m.
Beam	9'3"	2.77 m.
Sail area	360.2 sq. ft.	33.56 sq. m.
Displacement	7,000 lbs.	3,175.20 kg.
Ballast	Shoal 3,200 lbs.	1,452.8 kg.
	Deep 3,000 lbs.	1,362.0 kg.
Draft	Shoal 3'3"	.97 m.
	Deep 4'3"	1.27 m.
Mast height from waterline	36'3"	11.05 m.
	40'11"	12.47 m.
Headroom	6'1"	1.85 m.

Hunter 27

PLUMBING DIAGRAM

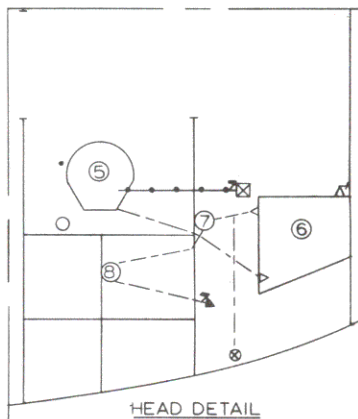
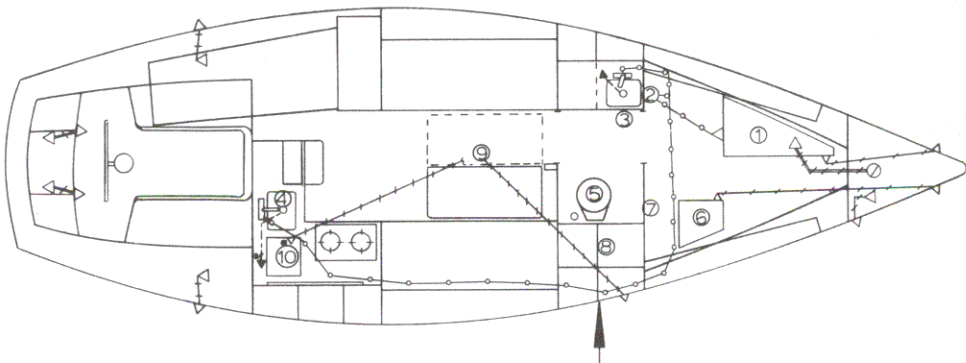

SUBSYSTEMS:
 FRESH WATER
 WASTE DISPOSAL
 DRAINS

LEGEND:

- ① FRESH WATER TANK
- ② WATER PUMP
- ③ VANITY
- ④ GALLEY
- ⑤ MANSFIELD HEAD
- ⑥ HOLDING TANK
- ⑦ № 10 WHALE GUSHER (HAND PUMP)
- ⑧ 1-1/2" VENTED LOOP (BRONZE)
- ⑨ BILGE PUMP
- ⑩ ICE BOX

HOSES & FITTINGS:

- 5/8" WHITE REINF. HOSE
- 5/8" BLACK HOSE (HEAD)
- /— 3/4" SHIELDVAC (W/CUFFS)
- /— 1-1/2" SHIELDVAC (W/CUFFS)
- 1-1/4" SHIELDFLEX (GREEN)
- 1-1/2" SHIELDFLEX (GREEN)
- △ THRU HULL (PLASTIC)
- ▲ THRU HULL (BRONZE)
- ∅ DECK PLATE (WATER)
- ⊗ DECK PLATE (WASTE)
- ⊠ SALT WATER PICKUP
- 7 GATE VALVE

Hunter 27

WIRING DIAGRAM (AC)

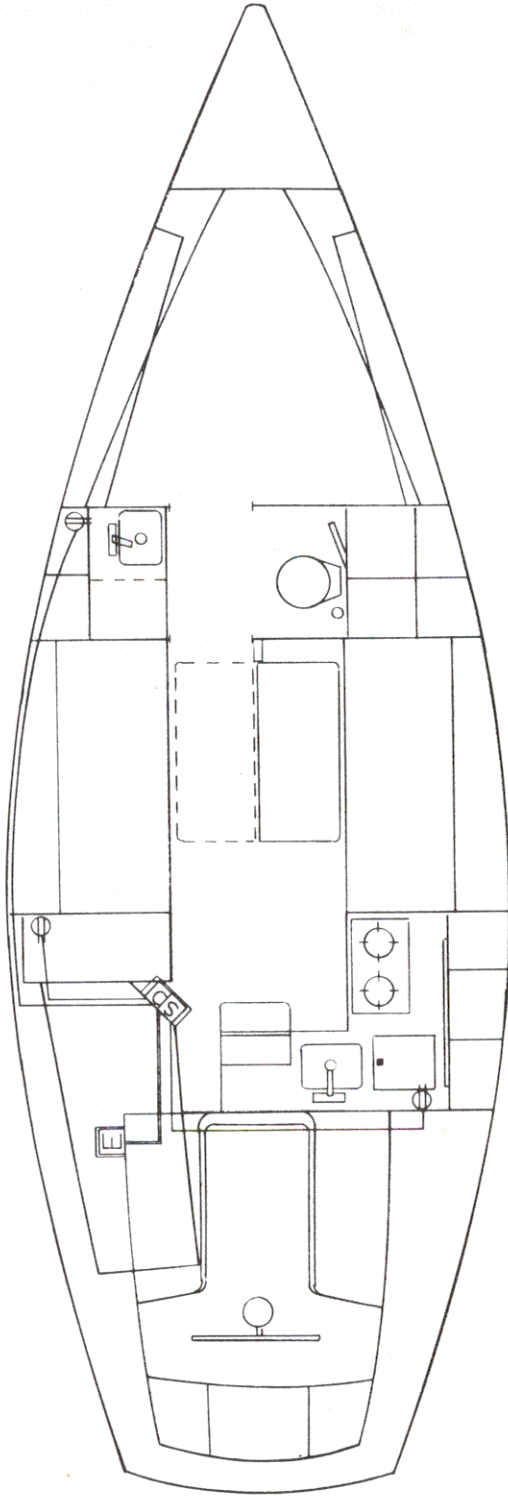

LEGEND:	
	ELECTRICAL DECK PLATE
	SWITCH PANEL
	110V OUTLET
	10/3 MARINE POWER CABLE (AC SUPPLY)
	14/3 MARINE POWER CABLE (TO OUTLETS)

Hunter 27

WIRING DIAGRAM (DC)

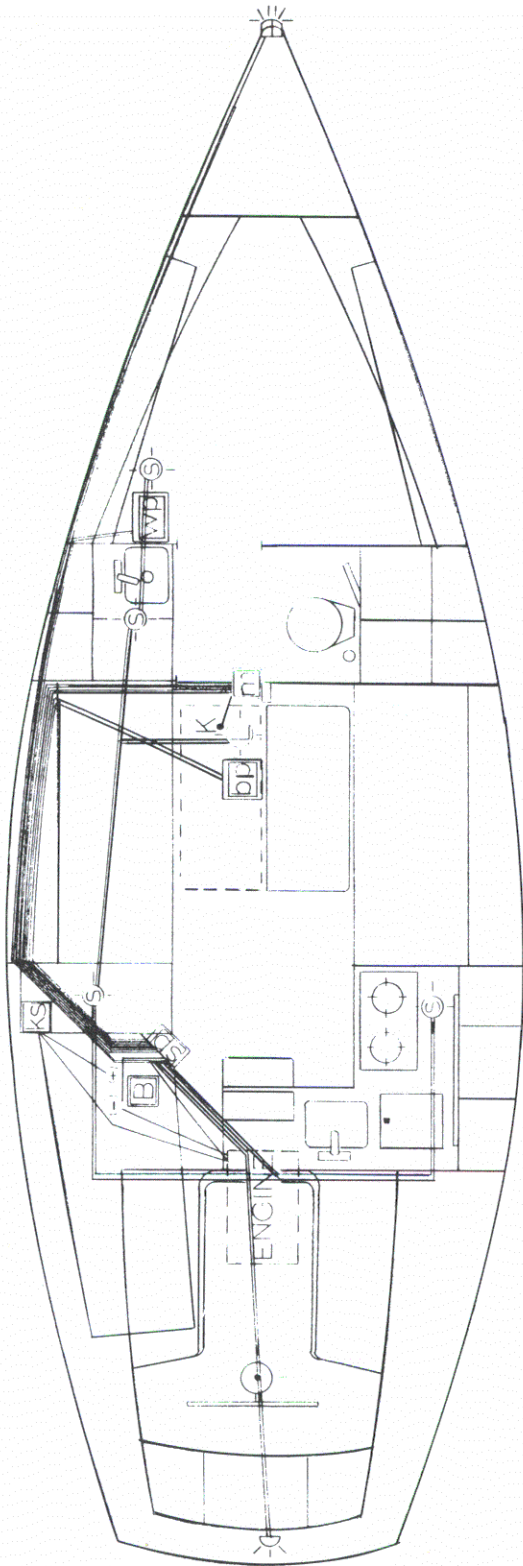

LEGEND:

	BATTERY (72 A)
	SWITCH PANEL
	KEY SWITCH
	WATER PUMP
	BILGE PUMP (400 GPH)
	MAST POST
	SMALL LIGHT
	LARGE LIGHT
	KEEL

WIRING NOTES:

COLOR	GAUGE	APPLICATION
RED	4	BATTERY CABLE /KEY SWITCH
WHITE	8	MAST GROUND
RED	10	DC SUPPLY TO SWITCH PANEL
RED	12	WATER PUMP
BLUE	16	CABIN LIGHTS
WHITE	16	RUNNING LIGHTS (BOW)
GREEN	16	STEAMING LIGHTS (STERN/COMPASS)
RED	16	ANCHOR LIGHT
BROWN	16	BILGE PUMP

*ALL LEADS 12 TO 16 GAUGE ARE RUN WITH A BLACK GROUND OF EQUAL GAUGE. THESE ARE CONNECTED TO A COMMON GROUND AT THE SWITCH PANEL WHICH IS GROUND TO THE BATTERY (-) WITH A 10 GAUGE BLACK WIRE.

Hunter 30

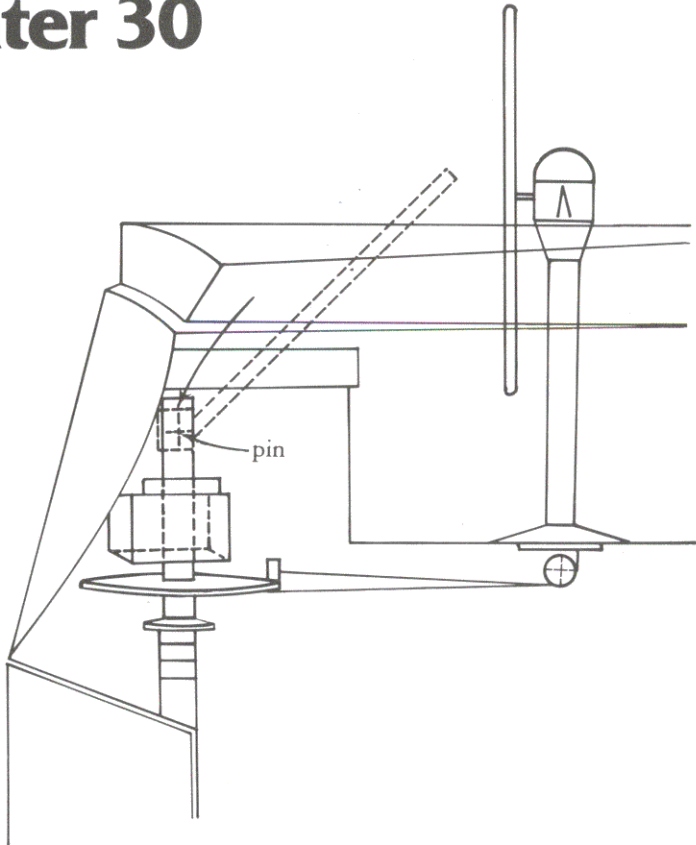

IMPORTANT LOCATIONS

EMERGENCY TILLER INSTALLATION: lift lazerette seat, remove pin in rudder shaft, fit emergency tiller brackets over rudder shaft, re-insert pin.

DIESEL FILLER: portside cockpit coaming.

WATER FILLERS: port and starboard side decks, amidships.

WASTE PUMP OUT: starboard side deck, forward.

DOCKSIDE POWER OUTLET: starboard cockpit coaming.

Hunter 30

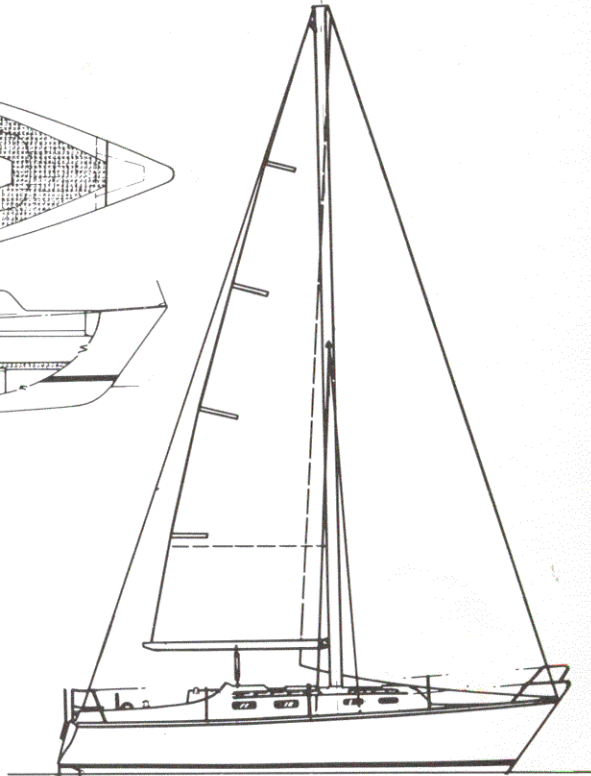
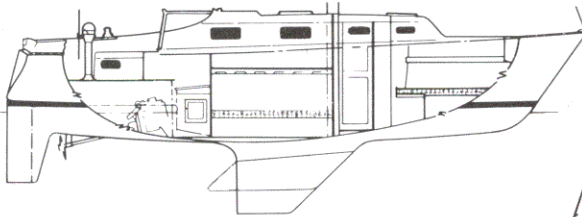
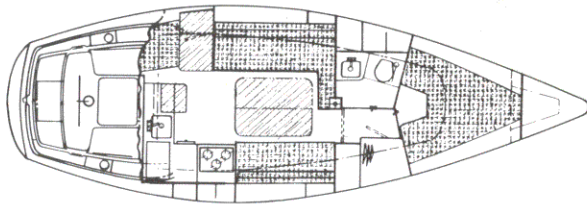

SPECIFICATIONS:

E (Mainsail foot)	10'9"	3.28 m.
J (Foretriangle base)	12'10"	3.91 m.
P (Mainsail luff)	37'0"	11.28 m.
I (Foretriangle ht.)	42'0"	17.80 m.
L.O.A.	29'11 1/2"	9.09 m.
L.W.L.	25'9"	7.83 m.
Beam	10'1 1/2"	3.04 m.
Sail area	473.1 sq. ft.	43.95 sq. m.
Displacement	9,700 lbs.	4,399.9 kg.
Ballast	Shoal 4,000 lbs.	1,816.00 kg.
	Deep 4,000 lbs.	1,816.00 kg.
Draft	Shaft 4'0"	1.20 m.
	Deep 5'3"	1.50 m.
Mast height	40'6"	12.34 m.
from waterline	47'0"	14.33 m.
Headroom	6'4"	1.90 m.

Hunter 30

PLUMBING DIAGRAM

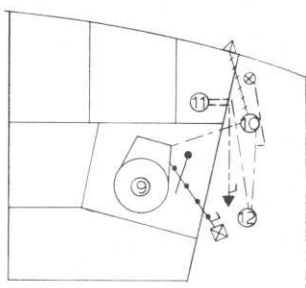

HEAD DETAIL

◆◆◆ 3/4" BLK. HOSE

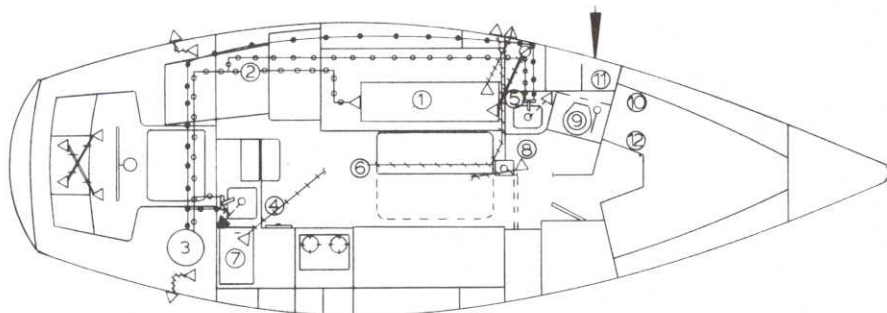

LEGEND:

- ① WATER TANK
- ② WATER PUMP
- ③ WATER HEATER
- ④ GALLEY
- ⑤ VANITY
- ⑥ BILGE PUMP (ELEC.)
- ⑦ ICEBOX
- ⑧ SHOWER
- ⑨ HEAD
- ⑩ HOLDING BAG
- ⑪ 1-1/2" VENTED LOOP (BRONZE)
- ⑫ WASTE PUMP (MANUAL)

HOSES & FITTINGS:

- ◆◆◆ 5/8" WH. HOSE (COLD WATER)
- ◆◆◆ 5/8" WH. HOSE (HOT WATER)
- |—|— 3/4" SHIELDVAC (W/CUFFS)
- |—|— 1-1/2" SHIELDVAC (W/CUFFS)
- |—|— 1-1/4" SHIELDFLEX (GREEN)
- |—|— 1-1/2" SHIELDFLEX (GREEN)
- △ THRU HULL (PLASTIC)
- ▲ THRU HULL (BRONZE)
- DECK PLATE (WATER)
- ⊗ DECK PLATE (WASTE)
- ⊠ SALT WATER PICKUP
- △ WATER & WASTE VENTS
- ∇ GATE VALVE

SUBSYSTEMS:
FRESH WATER
WASTE DISPOSAL
DRAINS

Hunter 30

WIRING DIAGRAM (AC)

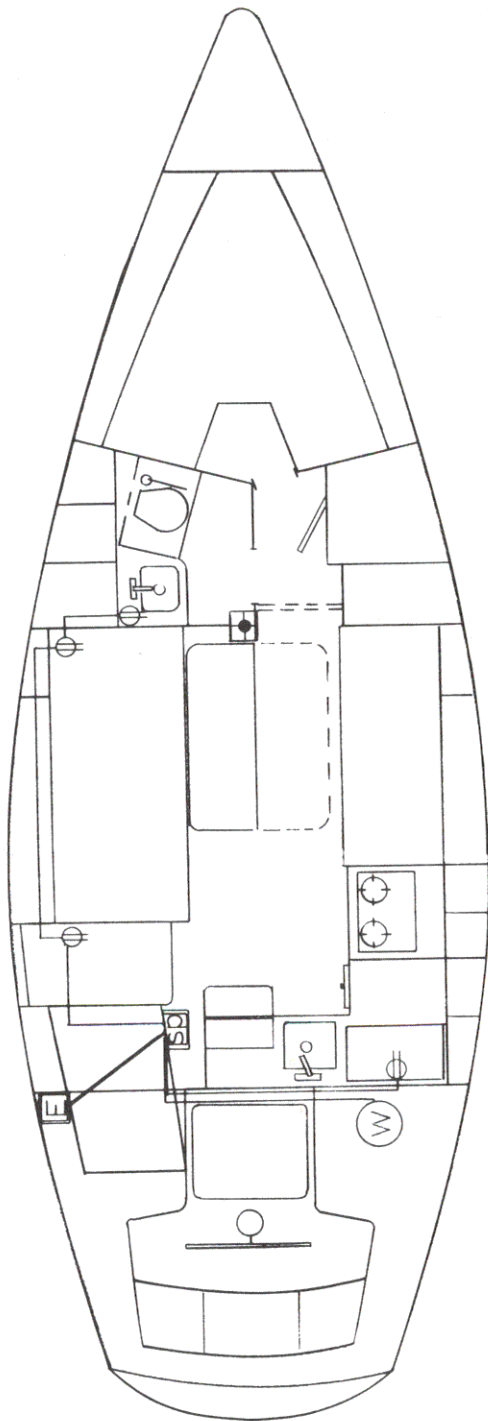

LEGEND:	
	ELECTRICAL DECK PLATE
	SWITCH PANEL
	WATER HEATER
	110v OUTLET
	10/3 MARINE POWER CABLE (AC SUPPLY)
	14/3 MARINE POWER CABLE (TO OUTLETS/WATER HEATER)

Hunter 30

WIRING DIAGRAM (DC)

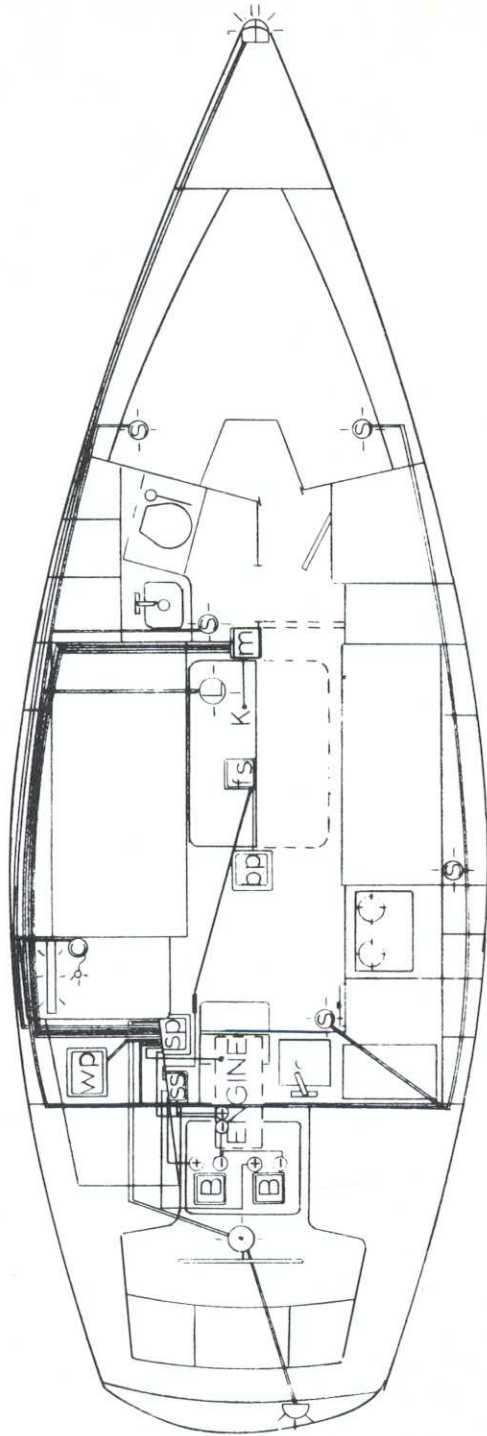

DC SUPPLY TO SWITCH PANEL

LEGEND:

B	BATTERY (2-72 A.)
SS	SWITCH PANEL
FS	SAFETY MAIN SWITCH
WP	WATER PUMP
BP	BILGE PUMP (750 GPH)
IS	FLOAT SWITCH
M	MAST
K	KEEL

⊙	SM. ROUND LIGHT
○	LG. ROUND LIGHT
⊖	LG. FLOOR LIGHT
⊖	SM. FLOOR LIGHT
⊖	CHART LIGHT
—	IN-LINE FUSE
⊙	FLOOR LIGHT AT CHART TABLE IS RED.

WIRING NOTES:

COLOR	GAUGE	APPLICATION
RED	4	BATTERY CABLE/SAFETY MAIN SW.
WHITE	8	MAST GROUND
RED	10	DC SUPPLY TO SWITCH PANEL
RED	12	WATER PUMP
BLUE	16	CABIN LIGHTS
WHITE	16	RUNNING LIGHTS (BOW)
GREEN	16	STEAMING LIGHTS (STERN/COMPASS)
RED	16	ANCHOR LIGHT
BROWN	16	BILGE PUMP
TAN	16	BILGE FLOAT SWITCH

● ALL LEADS EXCEPT FLOAT SWITCH AND MAST GRD) ARE RUN WITH BLACK GROUND OF EQUAL GAUGE. THESE ARE CONNECTED TO A COMMON GROUND AT THE SWITCH PANEL WHICH IS GROUNDED TO THE ENGINE WITH A 10 GAUGE BLACK WIRE.

Hunter 33

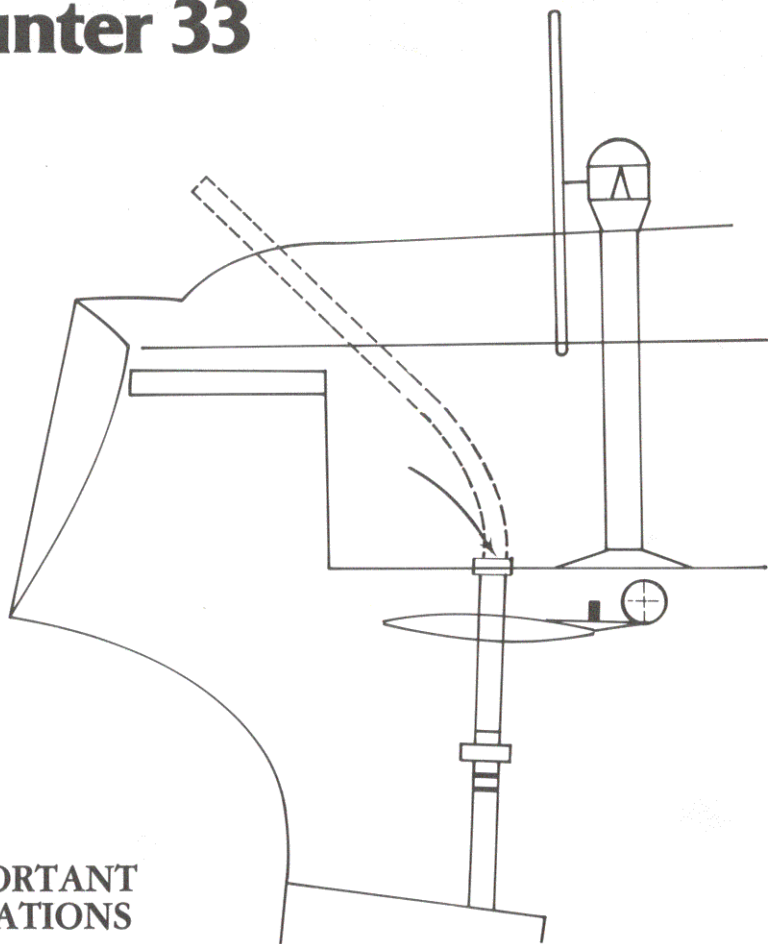

IMPORTANT LOCATIONS

EMERGENCY TILLER INSTALLATION: unscrew the protective cover plate on the cockpit sole, just aft of the steering pedestal. Insert the emergency tiller pointing aft onto the exposed rudder shaft.

DIESEL FILLER: center of the cockpit sole.

WATER FILLER: inside anchor well.

WASTE PUMP OUT: starboard side deck, forward.

DOCKSIDE POWER OUTLET: starboard cockpit coaming (next to engine panel).

Hunter 33

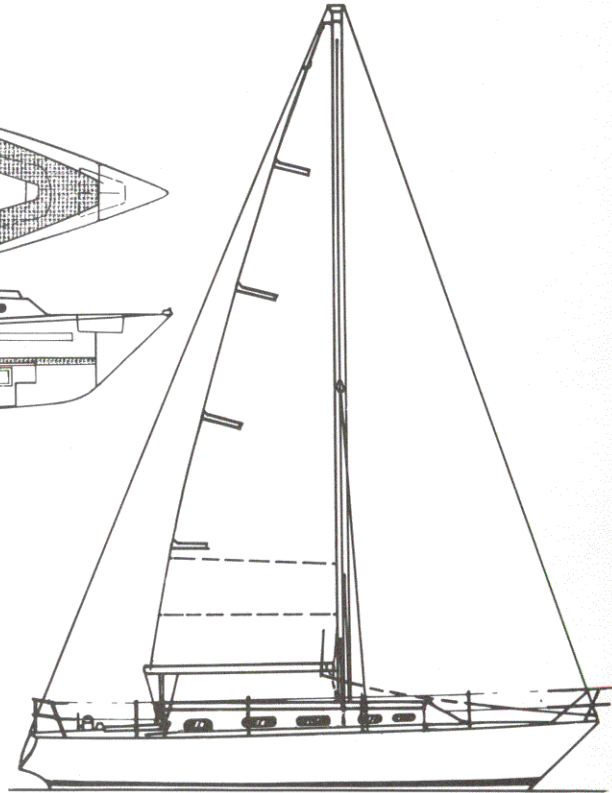
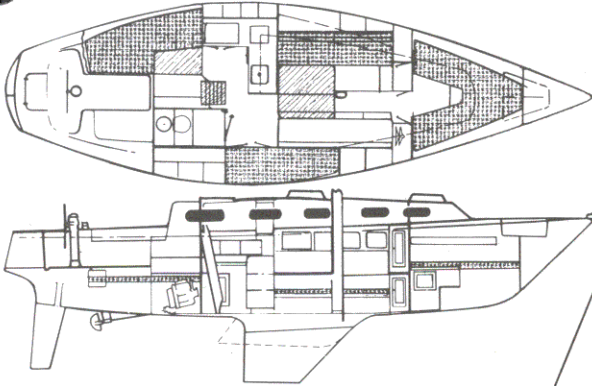

SPECIFICATIONS:

E (Mainsail foot)	10'9"	3.82 m.
J (Foretriangle base)	14'0"	4.40 m.
P (Mainsail luff)	37'1"	11.23 m.
I (Foretriangle ht.)	42'6"	12.95 m.
L.O.A.	32'8"	9.90 m.
L.W.L.	27'1"	8.23 m.
Beam	10'1 1/2"	41.10 m.
Sail area	496.7 sq. ft.	46.97 sq. m.
Displacement	10,600 lbs.	4,808.16 kg.
Ballast	Shoal 4,300 lbs.	1,952.20 kg.
	Deep 4,100 lbs.	1,862.40 kg.
Draft	Shoal 4'0"	1.20 m.
	Deep 5'3"	1.576 m.
Mast height	41'0"	12.50 m.
from waterline	47'3"	13.78 m.
Headroom	6'4"	1.90 m.

Hunter 33

PLUMBING DIAGRAM

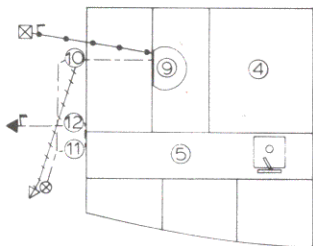
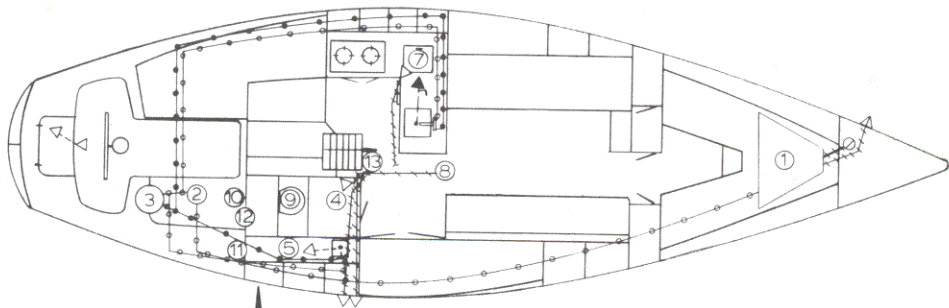

HEAD DETAIL
 —●— 3/4" BLK. HOSE

SUBSYSTEMS:
 FRESH WATER
 WASTE DISPOSAL
 DRAINS

LEGEND:	HOSES & FITTINGS:
① WATER TANK	—●— 5/8" WH. HOSE (COLD WATER)
② WATER PUMP	—●— 5/8" WH. HOSE (HOT WATER)
③ WATER HEATER	—●— 3/4" SHIELDVAC (W/CUFFS)
④ SHOWER	—●— 1-1/2" SHIELDVAC (W/CUFFS)
⑤ VANITY	—●— 1-1/4" SHIELDFLEX (GREEN)
⑥ GALLEY	—●— 1-1/2" SHIELDFLEX (GREEN)
⑦ ICEBOX	△ THRU HULL (PLASTIC)
⑧ BILGE PUMP (ELEC.)	▲ THRU HULL (BRONZE)
⑨ HEAD	○ DECK PLATE (WATER)
⑩ HOLDING BAG	⊗ DECK PLATE (WASTE)
⑪ WASTE PUMP (MANUAL)	⊠ SALT WATER PICKUP
⑫ 1-1/2" VENTED LOOP (BRONZE)	△ WATER & WASTE VENTS
⑬ BILGE PUMP/SHOWER	7 GATE VALVE

Hunter 33

WIRING DIAGRAM (AC)

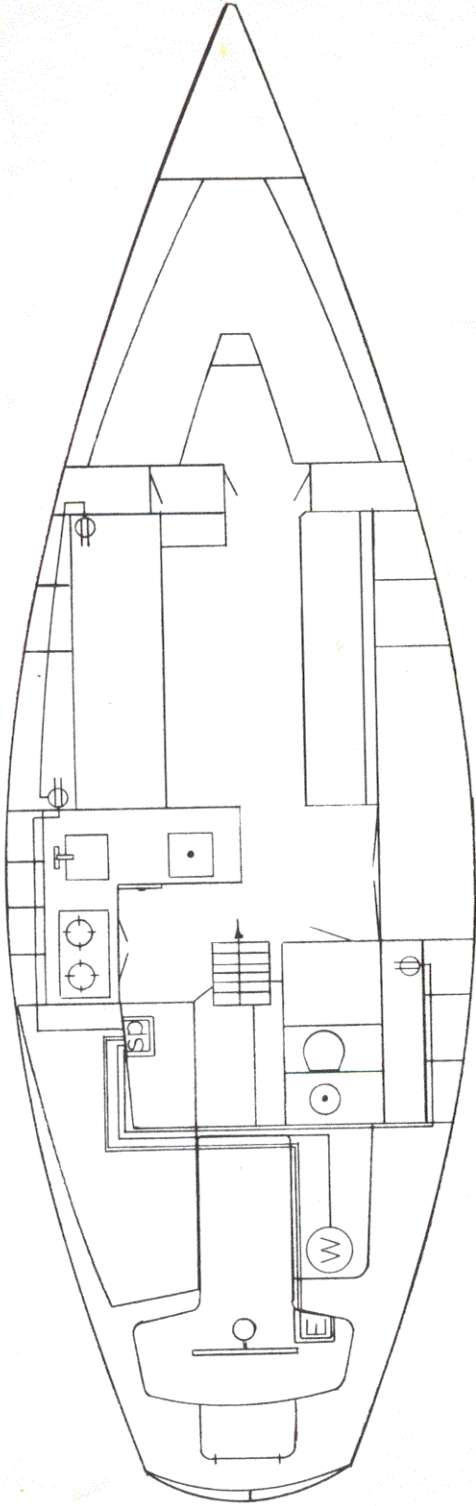

LEGEND:

- E** ELECTRICAL DECK PLATE
- SP** SWITCH PANEL
- W** WATER HEATER
- ⊕** 110V OUTLET
- 10/3 MARINE POWER CABLE (AC SUPPLY)
- 14/3 MARINE POWER CABLE (TO OUTLETS/WATER HEATER)

Hunter 33

WIRING DIAGRAM (DC)

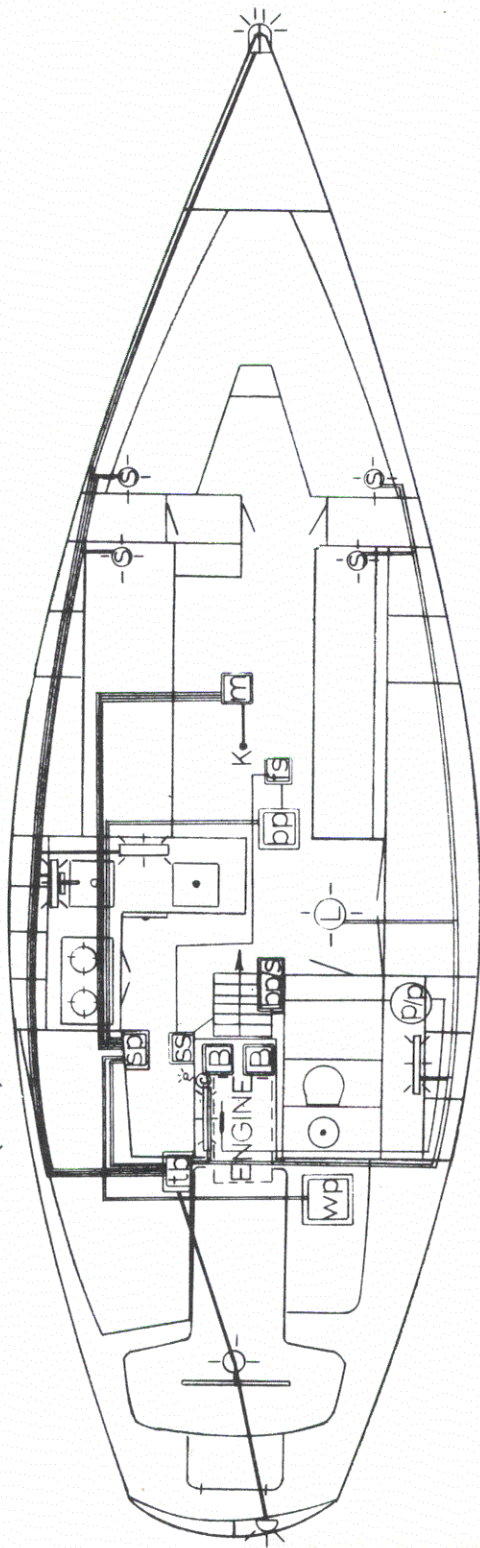

LEGEND:

	BATTERY (2-72 A.)
	SWITCH PANEL
	SAFETY MAIN SWITCH
	WATER PUMP
	BILGE PUMP (750 GPH)
	BILGE FLOAT SWITCH
	MAST
	BILGE PUMP/SHOWER (750 GPH)
	PUSH/PULL SWITCH
	TERMINAL BLOCK
	SM. ROUND LIGHT
	LG. ROUND LIGHT
	LG. FLOOR LIGHT
	SM. FLOOR LIGHT
	CHART LIGHT
	IN-LINE FUSE
	KEEL
	FLOOR LIGHT AT CHART TABLE IS RED.

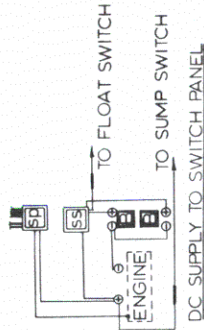

WIRING NOTES:

COLOR	GAUGE	APPLICATION
RED	4	BATTERY CABLE/SAFETY MAIN SW.
WHITE	8	MAST GROUND
RED	10	DC SUPPLY TO SWITCH PANEL
RED	12	WATER PUMP
BLUE	16	CABIN LIGHTS
WHITE	16	RUNNING LIGHTS (BOW)
GREEN	16	STEAMING LIGHTS (STERN/COMPASS)
RED	16	ANCHOR LIGHT
BROWN	16	BILGE PUMP
TAN	16	BILGE FLOAT SWITCH
<p>● ALL LEADS (EXCEPT FLOOR SWITCH AND MAST GROUND) ARE RUN WITH A BLACK GROUND OF EQUAL GAUGE. THESE ARE CONNECTED TO A COMMON GROUND AT THE SWITCH PANEL WHICH IS GROUNDED TO THE ENGINE WITH A 10 GAUGE BLACK WIRE.</p>		

Hunter 36

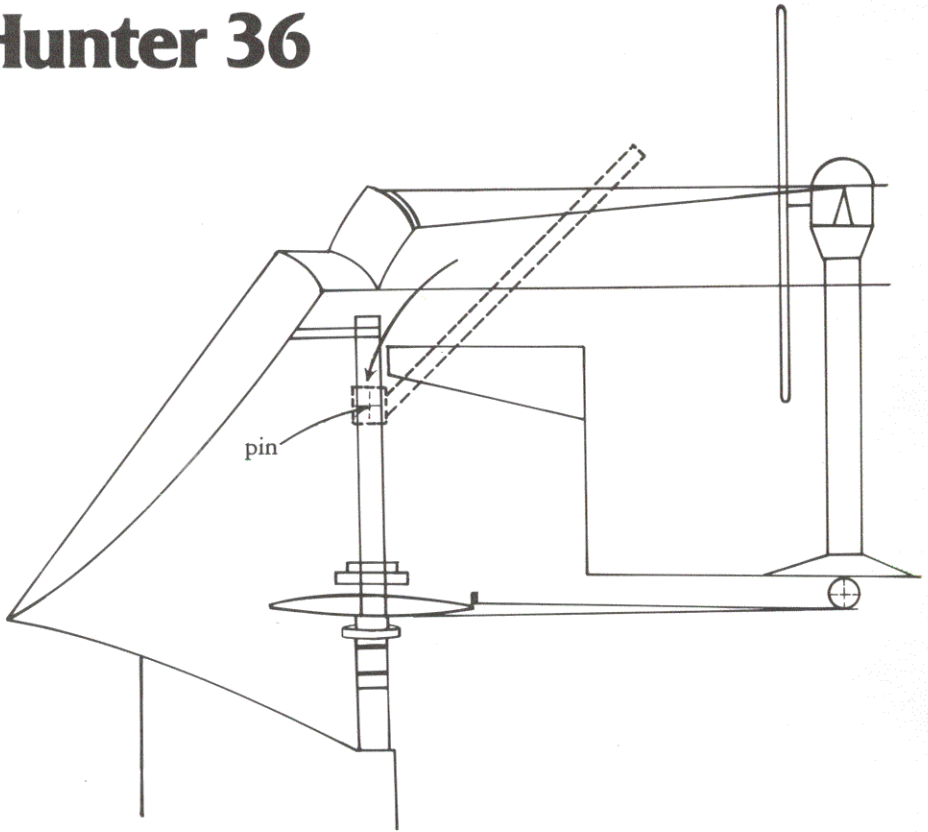

IMPORTANT LOCATIONS

EMERGENCY TILLER INSTALLATION: lift lazerette seat, remove pin in rudder shaft, fit emergency tiller brackets over rudder shaft, re-insert pin.

DIESEL FILLER: under lazerette seat.

WATER FILLER: port side deck.

WASTE PUMP OUT: starboard side deck forward.

DOCKSIDE POWER OUTLET: outside port cockpit coaming.

Hunter 36

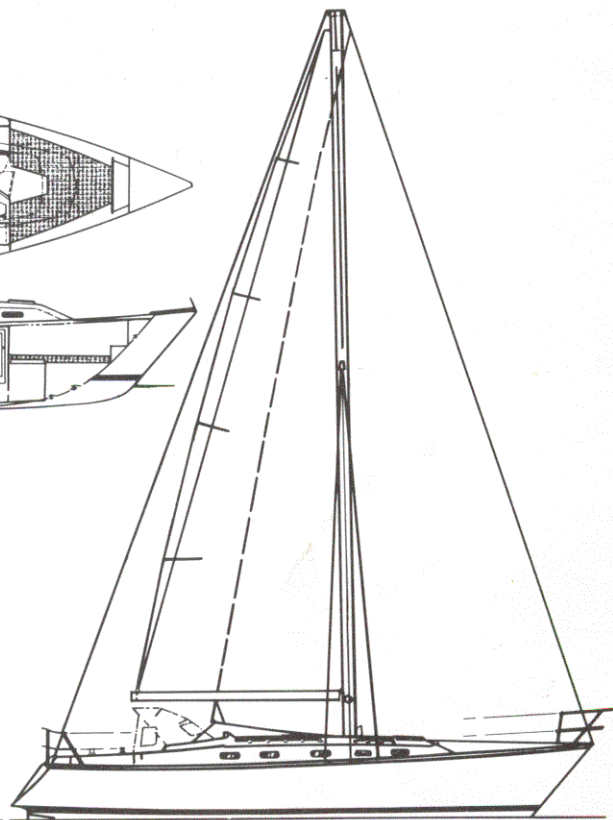
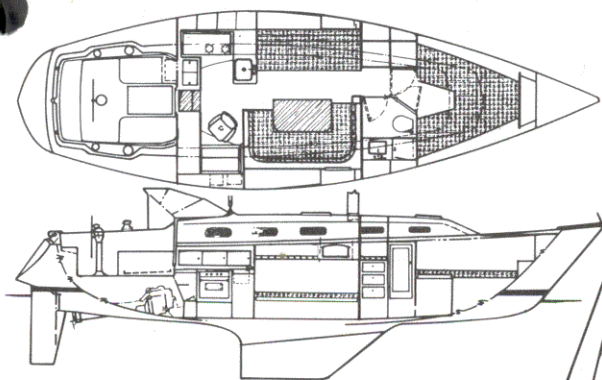

SPECIFICATIONS:

E (Mainsail foot)	12'9"	3.68 m.
J (Foretriangle base)	14'9"	4.29 m.
P (Mainsail luff)	41'0"	12.40 m.
I (Foretriangle ht.)	46'6"	14.03 m.
L.O.A.	35'11"	10.80 m.
L.W.L.	29'6"	9.00 m.
Beam	11'1"	3.40 m.
Sail area	621 sq. ft.	57.69 sq. m.
Displacement	13,500 lbs.	6,125.20 kg.
Ballast	6,000 lbs.	2,724.00 kg.
Draft	4'11"	1.40 m.
Mast height	45'6"	13.87 m.
from waterline	50'6"	15.39 m.
Headroom	6'5"	1.96 m.

Hunter 36

PLUMBING DIAGRAM

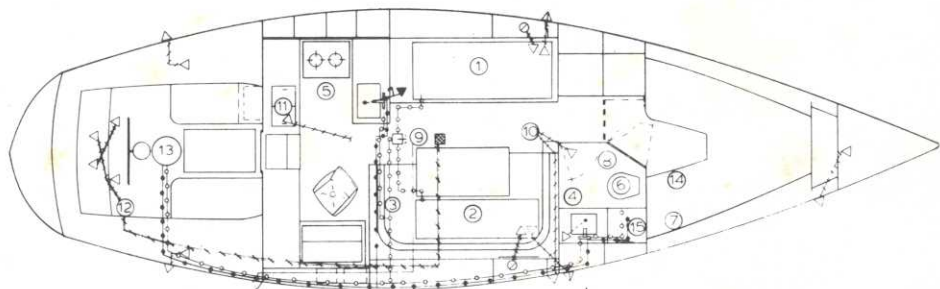

SUBSYSTEMS
 FRESH WATER
 WASTE DISPOSAL
 DRAINS

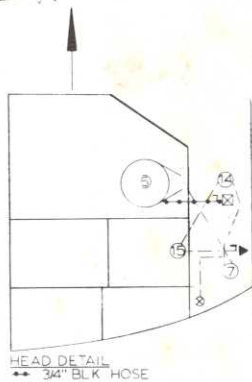

LEGEND:

- ① WATER TANK (PORT)
- ② WATER TANK (STBD)
- ③ WATER PUMP
- ④ VANITY
- ⑤ GALLEY
- ⑥ HEAD
- ⑦ HOLDING BAG
- ⑧ SHOWER
- ⑨ BILGE PUMP (ELEC.)
- ⑩ SUMP PUMP/SHOWER
- ⑪ ICEBOX
- ⑫ BILGE PUMP (MANUAL)
- ⑬ WATER HEATER
- ⑭ WASTE PUMP (MANUAL)
- ⑮ 1-1/2" VENTED LOOP (BRZ)

HOSES & FITTINGS:

- ↔ 5/8" WHITE HOSE (COLD WATER)
- ↔ 5/8" WHITE HOSE (HOT WATER)
- ↔ 3/4" SHIELDVAC (W/CUFFS)
- ↔ 1-1/2" SHIELDVAC (W/CUFFS)
- 1-1/4" SHIELDFLEX (GREEN)
- 1-1/2" SHIELDFLEX (GREEN)
- △ THRU HULL (PLASTIC)
- ▲ THRU HULL (BRONZE)
- DECK PLATE (WATER)
- ⊗ DECK PLATE (WASTE)
- ⊗ SALT WATER PICKUP
- ⊗ NAVY STRAINER
- △ WATER & WASTE VENTS
- ⌋ GATE VALVE
- ⊕ 3-WAY VALVE

Hunter 36

WIRING DIAGRAM (AC)

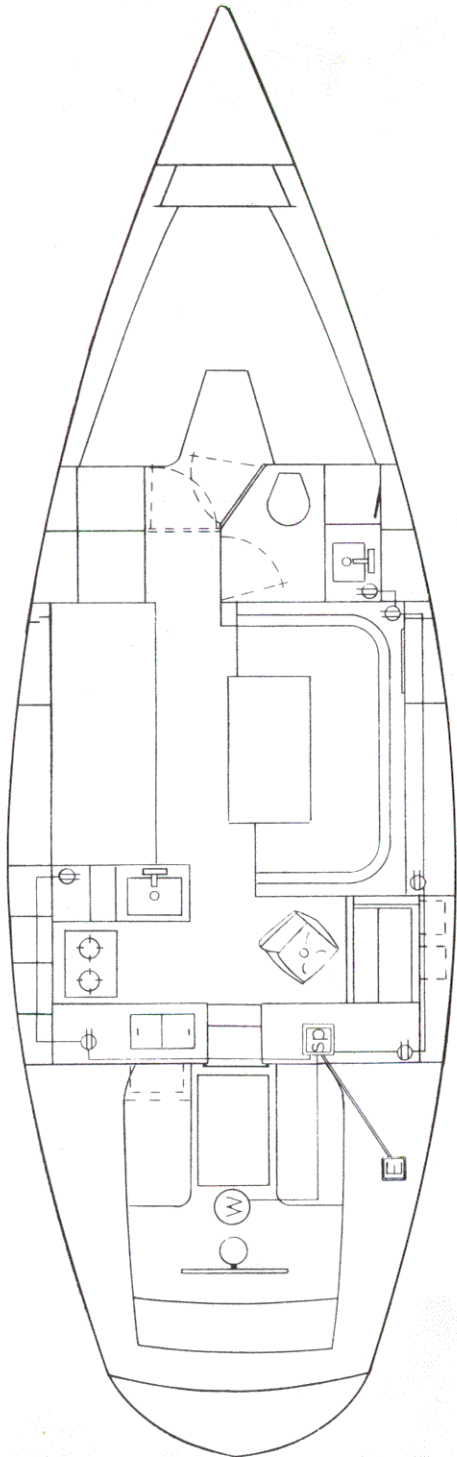

LEGEND:	
	ELECTRICAL DECK PLATE
	SWITCH PANEL
	WATER HEATER
	110V OUTLET
	10/3 MARINE POWER CABLE (AC SUPPLY)
	14/3 MARINE POWER CABLE (TO OUTLETS/WATER HEATER)

Hunter 36

WIRING DIAGRAM (DC)

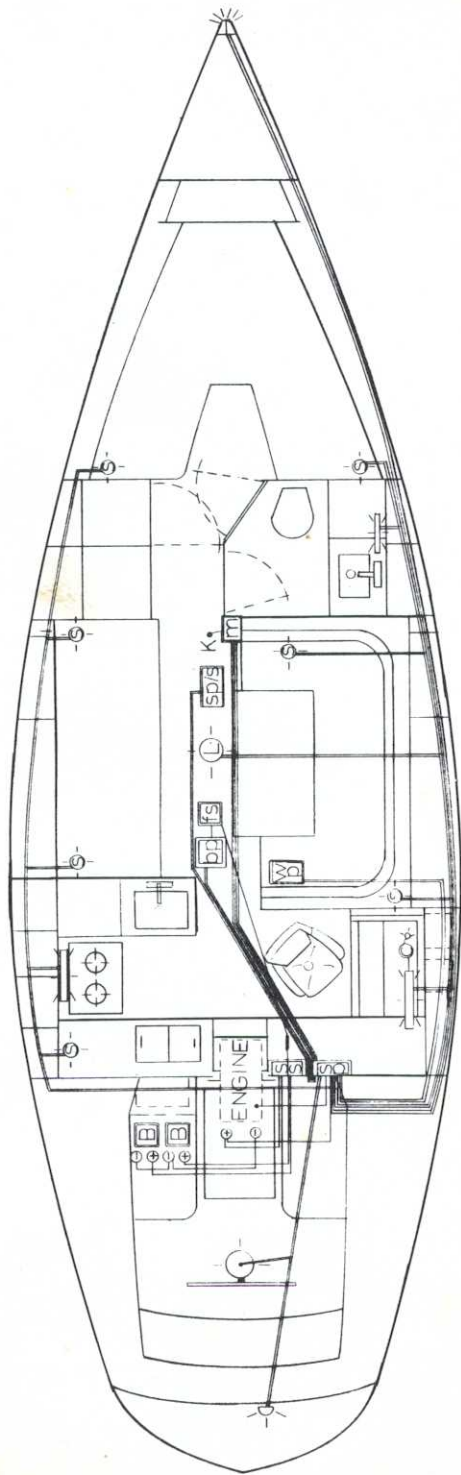

LEGEND

B	BATTERY (2-85 A)	SM	ROUND LIGHT
SP	SWITCH PANEL	LG	ROUND LIGHT
SS	SAFETY MAIN SWITCH	LG	FLOOR LIGHT
WP	WATER PUMP	SM	FLOOR LIGHT
BL	BILGE PUMP (1500 GPH)	CL	CHART LIGHT
DF	BILGE FLOAT SWITCH	IF	IN-LINE FUSE
FS	RUMP PUMP/SHOWER (750 GPH)	FL	FLOOR LIGHT AT CHART TABLE IS RED.
MT	MAST		

ELECTRICAL DIAGRAM (DC)
NUMBER 16
NO SCALE

WIRING NOTES:

COLOR	GAUGE	APPLICATION
RED	4	BATTERY CABLE/SAFETY MAIN SW
WHITE	8	MAST GROUND TO SWITCH PANEL
RED	10	DC SUPPLY TO SWITCH PANEL
RED	12	WATER PUMP
BLUE	16	CABIN LIGHTS
WHITE	16	RUNNING LIGHTS (BOW)
GREEN	16	STEAMING LIGHTS (STERN/COMPASS)
RED	16	ANCHOR LIGHT
BROWN	16	BILGE FLOAT SWITCH
TAN	16	BILGE FLOAT SWITCH
BLACK	16	WATER PUMP/SHOWER (COMMON GROUND)
ALL		LEADS (EXCEPT BLACK GROUND OF EQUAL GAUGE) ARE RUN WITH A BLACK GROUND OF EQUAL GAUGE
		THESE ARE CONNECTED TO A COMMON GROUND AT THE SWITCH PANEL WHICH IS GROUND TO THE ENGINE WITH A 10 GAUGE BLACK WIRE.

Hunter 37

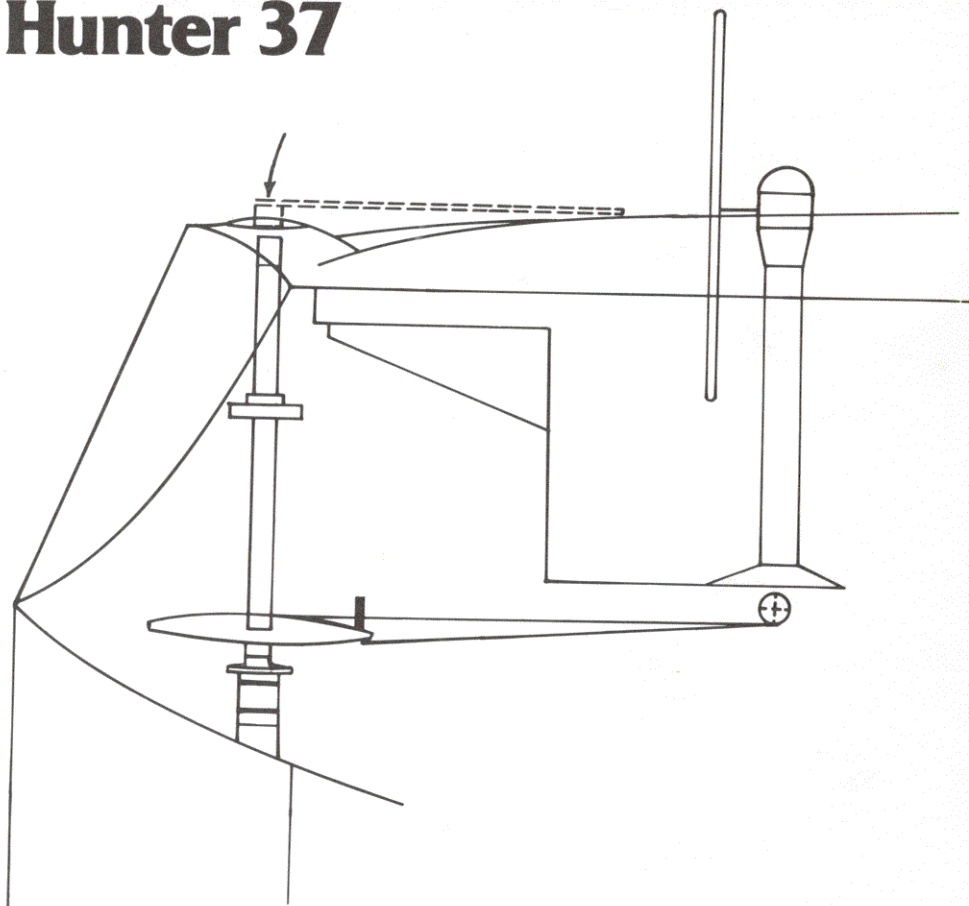

IMPORTANT LOCATIONS

EMERGENCY TILLER INSTALLATION: unscrew protective cover plate on stern cockpit coaming, insert the emergency tiller onto the exposed rudder shaft.

DIESEL FILLER: under starboard cockpit seat, aft.

WATER FILLER: starboard and port side decks, amidships.

WASTE PUMP OUT: starboard side deck forward.

DOCKSIDE POWER OUTLET: starboard cockpit coaming.

Hunter 37

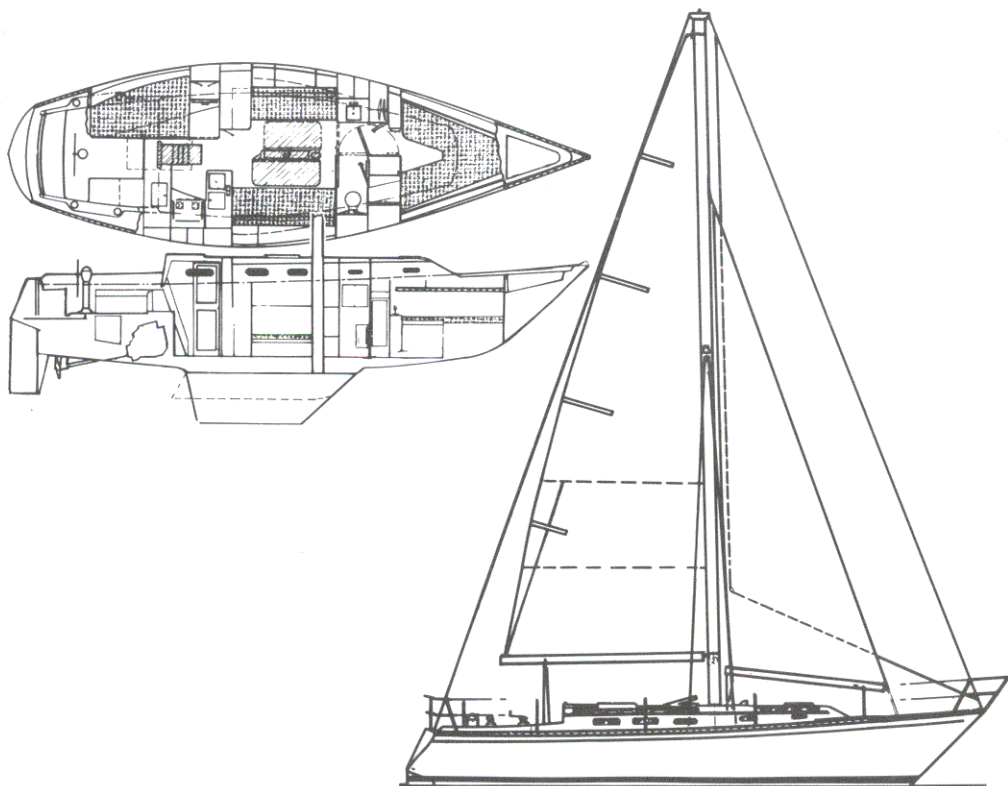

SPECIFICATIONS:

E (Mainsail foot)	13'0"	3.90 m.
J (Foretriangle base)	17'0"	5.10 m.
P (Mainsail luff)	39'6"	11.96 m.
I (Foretriangle ht.)	46'2"	14.05 m.
L.O.A.	37'0"	11.30 m.
L.W.L.	30'0"	9.10 m.
Beam	11'10 1/2"	3.40 m.
Sail area	710 sq. ft.	65.96 sq. m.
Displacement	17,800 lbs.	8,074.08 kg.
Ballast	Shoal 7,150 lbs.	3,246.00 kg.
	Deep 6,850 lbs.	3,110.00 kg.
Draft	Shoal 4'0"	1.20 m.
	Deep 5'1"	1.55 m.
Mast height from waterline	44'11"	13.69 m.
	50'0"	15.24 m.
Headroom	6'4"	1.93 m.

Hunter 37

PLUMBING DIAGRAM

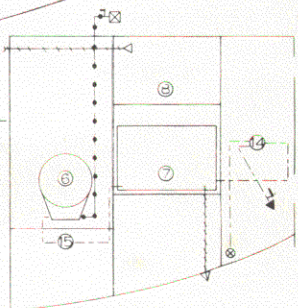
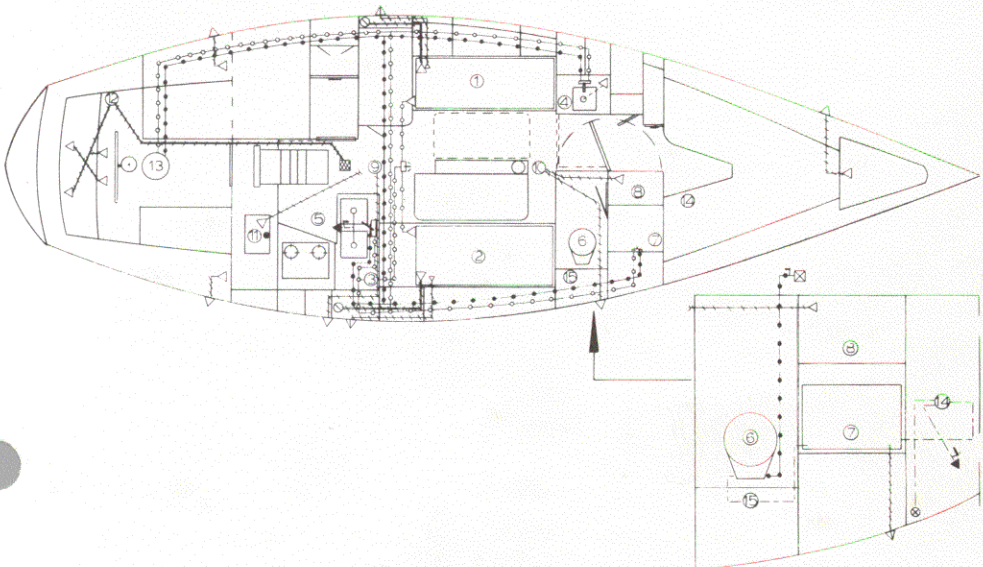

HEAD DETAIL
 ↔ 3/4" BLK HOSE

LEGEND	HOSES & FITTINGS
① WATER TANK (PORT)	—•—•— 5/8" WH. HOSE (COLD WATER)
② WATER TANK (STBD)	—••—••— 5/8" WH. HOSE (HOT WATER)
③ WATER PUMP	—•—•— 3/4" SHIELDVAC (W/CUFFS)
④ VANITY	—•—•— 1-1/2" SHIELDVAC (W/CUFFS)
⑤ GALLEY	—•—•— 1-1/4" SHIELDFLEX (GREEN)
⑥ HEAD	—•—•— 1-1/2" SHIELDFLEX (GREEN)
⑦ HOLDING TANK	△ THRU HULL (PLASTIC)
⑧ SHOWER	▲ THRU HULL (BRONZE)
⑨ BILGE PUMP (ELEC.)	○ DECK PLATE (WATER)
⑩ SUMP PUMP/SHOWER (ELEC.)	⊗ DECK PLATE (WASTE)
⑪ ICEBOX	⊠ SALT WATER PICKUP
⑫ BILGE PUMP (MANUAL)	⊞ NAVY STRAINER
⑬ WATER HEATER	△ WATER & WASTE VENTS
⑭ WASTE PUMP (MANUAL)	7 GATE VALVE
⑮ 1-1/2" VENTED LOOP (BRZ)	⊞ 3-WAY VALVE

SUBSYSTEMS:
 FRESH WATER
 WASTE DISPOSAL
 DRAINS

Hunter 37

WIRING DIAGRAM (AC)

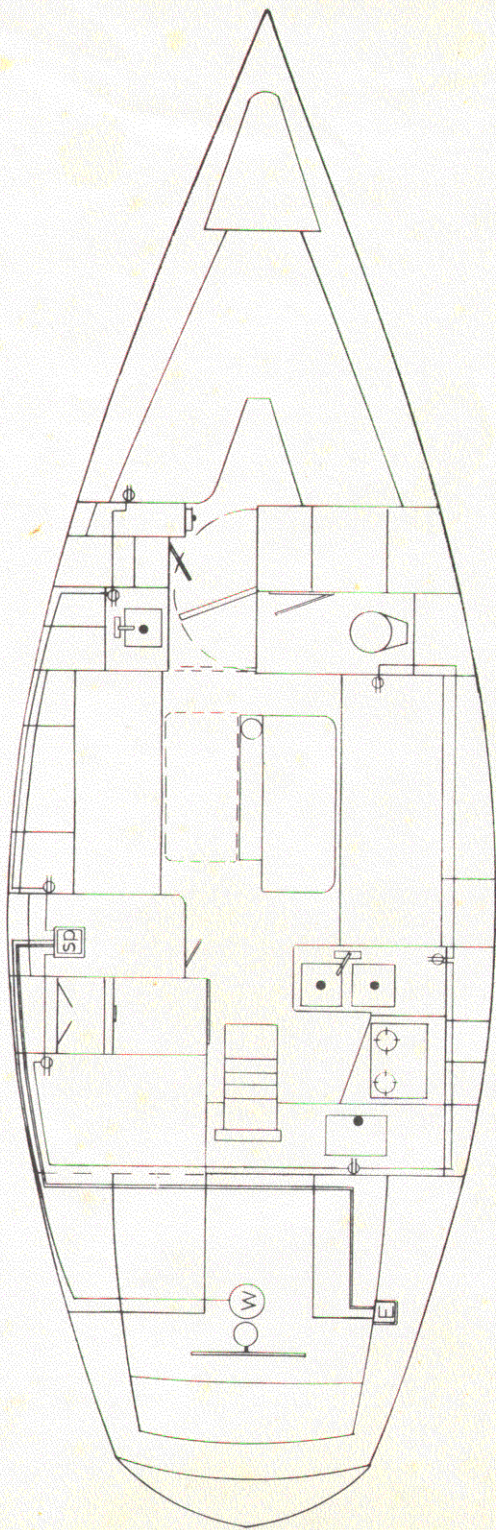

LEGEND	
E	ELECTRICAL DECK PLATE
SP	SWITCH PANEL
W	WATER HEATER
O	110V OUTLETS
—	10/3 MARINE POWER CABLE (AC SUPPLY)
—	14/3 MARINE POWER CABLE (TO OUTLETS/WATER HEATER)

Hunter 37

WIRING DIAGRAM (DC)

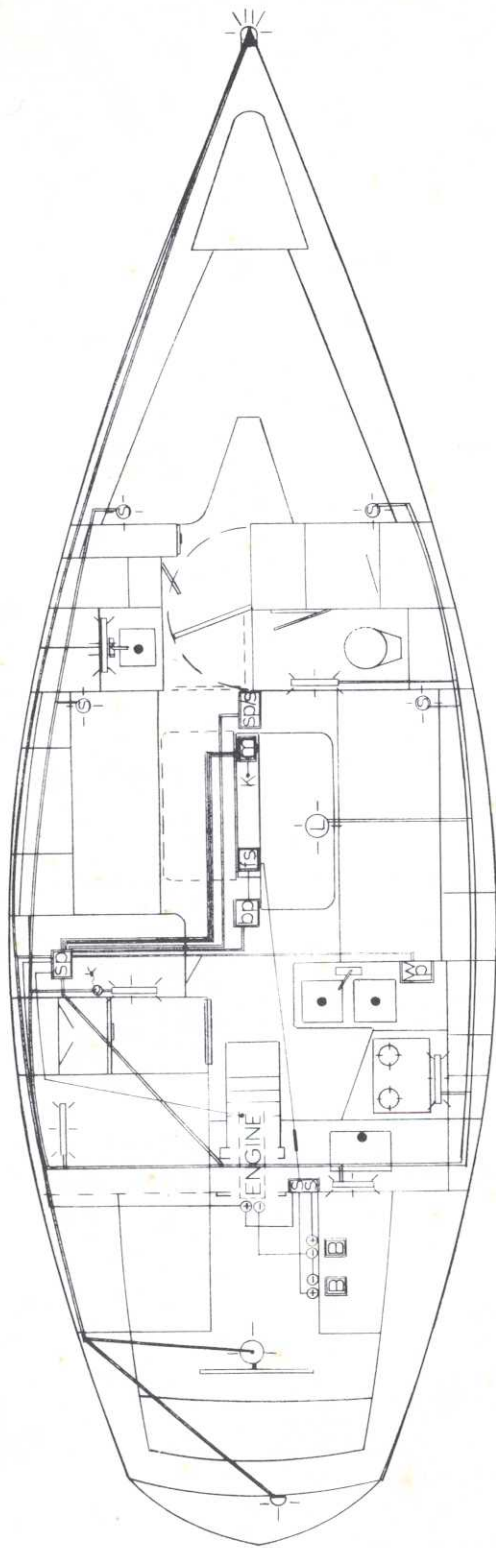

LEGEND:	
	BATTERY (2-85 A)
	SWITCH PANEL
	SAFETY MAIN SWITCH
	WATER PUMP
	BILGE PUMP (1500 GPH)
	BILGE FLOAT SWITCH
	SUMP PUMP/SHOWER (750 GPH)
	MAST
	SM: ROUND LIGHT
	LG: FLOOR LIGHT
	LG: FLOOR LIGHT
	SM: FLOOR LIGHT
	CHART LIGHT
	IN-LINE FUSE
	FLUOR LIGHT AT CHART TABLE IS RED.

WIRING NOTES:		
COLOR	GAUGE	APPLICATION
RED	4	BATTERY CABLE/SAFETY MAIN SWITCH
RED	10	BATTERY CABLE
RED	12	DC SUPPLY TO SWITCH PANEL
BLUE	16	WATER PUMP
WHITE	16	CABIN LIGHTS
GREEN	16	RUNNING LIGHTS (BOW)
BROWN	16	STEERING LIGHTS (STERN/COMPASS)
BROWN	16	ANCHOR LIGHT
TAN	16	BILGE PUMP
YELLOW	16	BILGE FLOAT SWITCH
	16	SUMP PUMP/SHOWER
	16	ALL LEADS EXCEPT FLOAT SWITCH AND MAST GROUND
		ARE RUN WITH A BLACK GROUNDING AND BROWN GROUNDING
		ARE RUN WITH A BLACK GROUNDING AND BROWN GROUNDING
		SWITCH PANEL WHICH IS GROUND TO THE ENGINE
		WITH A 10 GAUGE BLACK WIRE.

Scanned by: Jim Boernge
S/V Short Circuit

For the good of all Hunter Sailors

Document found on my 1981 Hunter 36
circa 1981

Scanned as found